

# High Static Pressure Duct Fan Coil Unit

|                                  |           |
|----------------------------------|-----------|
| <b>1. Introduction</b>           | <b>2</b>  |
| <b>2. Nomenclature</b>           | <b>2</b>  |
| <b>3. Product Schedule</b>       | <b>3</b>  |
| <b>4. External Appearance</b>    | <b>3</b>  |
| <b>5. Features</b>               | <b>4</b>  |
| <b>6. Specifications</b>         | <b>5</b>  |
| <b>7. Dimension</b>              | <b>7</b>  |
| <b>8. Wiring Diagrams</b>        | <b>8</b>  |
| <b>9. Capacity Tables</b>        | <b>9</b>  |
| <b>10. Static Pressure Graph</b> | <b>18</b> |
| <b>11. Exploded View</b>         | <b>22</b> |
| <b>12. Installation</b>          | <b>26</b> |

### 1. Introduction

Fan coil unit is a kind of compound device which assemble fan and surface-type coil heating-exchanger together. Fan coil with fresh air supply system is a main type of center air-conditioner system, so it is an important component of AC devices. Fan coil has horizontal type, vertical type, etc. A cooling (heating) supply system usually consists of fan coil terminals and chilled water system (heated water system).

**MDV**<sup>®</sup> commercial AC fan coil is designed and manufactured on the base of advanced technology, and utilize qualified galvanized iron as material. Due to its supper-thin design, it has such advantages: beautiful outlook, space saving, easy installation, etc. And the most obvious advantage is that it can decrease the outlet air Temp-difference as low as possible to make room more comfortable, as well as don't decrease cooling capacity output. For the large air flow volume design, it can increase room ventilation frequency, supply more flesh air, and balance room temperature distribution. Benefiting from adoption of advanced material and technology, it can effectively decrease the running noise and keep running smoothly. With the advantages above, it can be widely applied in market, hospital, office building, hotel airport, etc..

### 2. Nomenclature

# MD K T3H - 800EG70

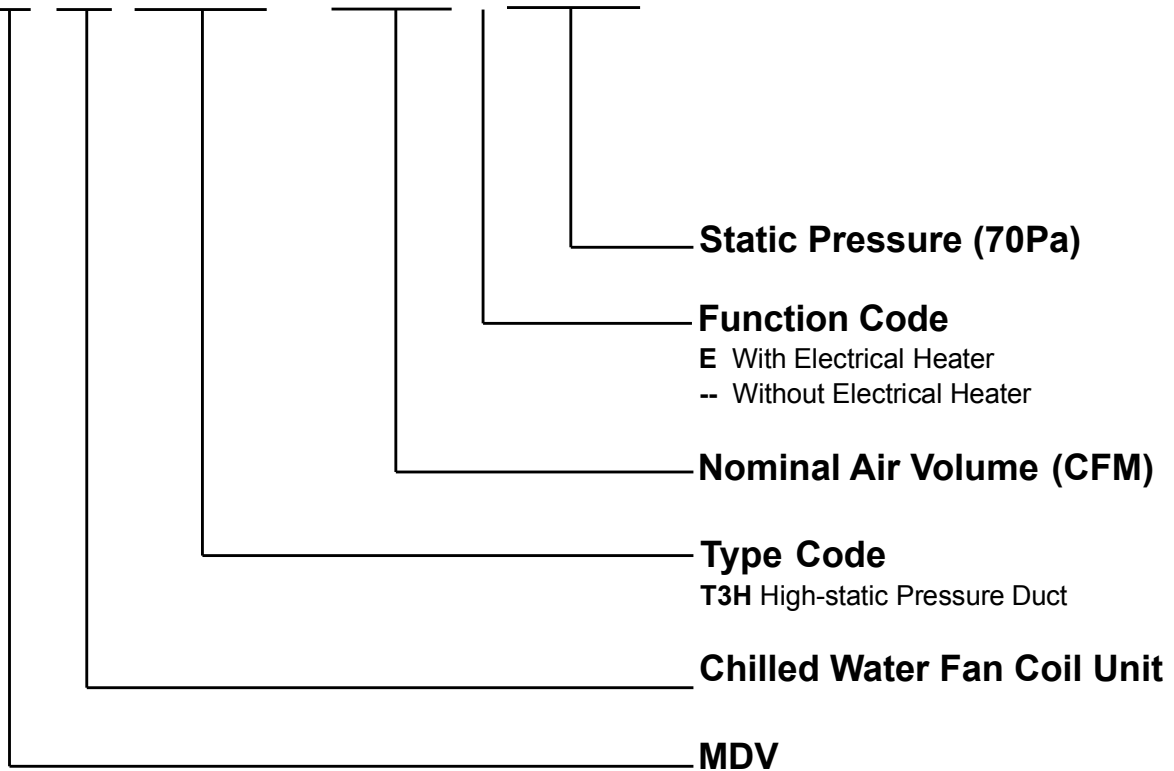

### 3. Product Schedule

| Model            | Static pressure (Pa) | Air volume (CFM) | Power supply      | Auxiliary Electrical Heater |                   |                   |
|------------------|----------------------|------------------|-------------------|-----------------------------|-------------------|-------------------|
| MDKT3H-800G70    | 70                   | 800              | 220~240V-1Ph-50Hz | Without                     |                   |                   |
| MDKT3H-1000G70   |                      | 1000             |                   |                             |                   |                   |
| MDKT3H-1200G70   |                      | 1200             |                   |                             |                   |                   |
| MDKT3H-1400G70   |                      | 1400             |                   |                             |                   |                   |
| MDKT3H-800EG70   | 70                   | 800              |                   | 220~240V-1Ph-50Hz           | With              |                   |
| MDKT3H-1000EG70  |                      | 1000             |                   |                             |                   |                   |
| MDKT3H-1200EG70  |                      | 1200             |                   |                             |                   |                   |
| MDKT3H-1400EG70  |                      | 1400             |                   |                             |                   |                   |
| MDKT3H-1600G100  | 100                  | 1600             |                   |                             | 220~240V-1Ph-50Hz | Without           |
| MDKT3H-1800G100  |                      | 1800             |                   |                             |                   |                   |
| MDKT3H-2200G100  |                      | 2200             |                   |                             |                   |                   |
| MDKT3H-1600EG100 | 100                  | 1600             |                   |                             |                   | 220~240V-1Ph-50Hz |
| MDKT3H-1800EG100 |                      | 1800             |                   |                             |                   |                   |
| MDKT3H-2200EG100 |                      | 2200             |                   |                             |                   |                   |

### 4. External Appearance

MDKT3H-800G70; MDKT3H-1000G70  
MDKT3H-1200G70; MDKT3H-1400G70



MDKT3-1600G100; MDKT3H-1800G100  
MDKT3-2200G100



MDKT3H-800EG70; MDKT3H-1000EG70  
MDKT3H-1200EG70; MDKT3H-1400EG70



MDKT3-1600EG100; MDKT3H-1800EG100  
MDKT3-2200EG100



## 5. Features

- High air volume, high static pressure, high capacity
- High-pressure centrifugal fans
- Easy to clean and change the air filter

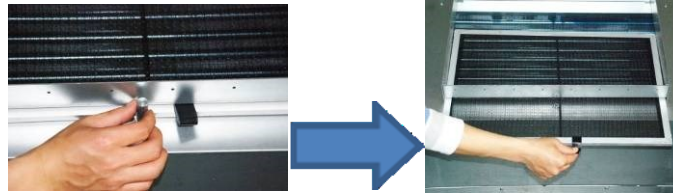

- Auxiliary electrical heater is optional



- Flexible control, no standard controller, remote controller and wired controller are optional
- Standard extended drainage pan for protecting your ceiling better



- Four-speed motor with super-high speed reserved
- Pipe connection from left or right can be selected (in factory)

## 6. Specifications

|                               |                         |                   |                                    |                             |                     |                     |                 |
|-------------------------------|-------------------------|-------------------|------------------------------------|-----------------------------|---------------------|---------------------|-----------------|
| Model MDKT3H-                 |                         |                   | 800G70<br>800EG70                  | 1000G70<br>1000EG70         | 1200G70<br>1200EG70 | 1400G70<br>1400EG70 |                 |
| Air flow                      | H/M/L                   | m <sup>3</sup> /h | 1360/1220/1090                     | 1700/1530/1380              | 2040/1880/1610      | 2380/2120/1860      |                 |
|                               | H/M/L                   | CFM               | 800/720/640                        | 1000/900/810                | 1200/1105/950       | 1400/1250/1095      |                 |
| External Static pressure      |                         | Pa                | 70                                 |                             |                     |                     |                 |
| Cooling                       | Capacity                | H/M/L             | kW                                 | 6.6/6.37/6.12               | 8.8/8.19/7.57       | 10/9.44/8.53        | 12/11.47/10.24  |
|                               | Water flow rate         | H                 | L/h                                | 1135                        | 1514                | 1720                | 2064            |
|                               | Water pressure drop     | H                 | kPa                                | 8                           | 24                  | 24                  | 36              |
| Heating                       | Capacity                | H/M/L             | kW                                 | 9.7/8.54/7.18               | 13.2/11.48/9.9      | 15/12.9/11.25       | 17.9/15.75/13.6 |
|                               | Water pressure drop     | H                 | kPa                                | 8.4                         | 25                  | 23.4                | 34.2            |
| Power supply                  |                         | V/Ph/Hz           | 220-240/1/50                       |                             |                     |                     |                 |
| Power input                   | H                       | W                 | 320                                | 350                         | 350                 | 350                 |                 |
| Current input                 | H                       | A                 | 1.46                               | 1.6                         | 1.6                 | 1.6                 |                 |
| Electric heater capacity (*E) |                         | W                 | 5000                               | 5000                        | 5000                | 5000                |                 |
| Sound pressure level          | H/M/L                   | dB(A)             | 49/42/35                           | 50/43/36                    | 51/44/37            | 52/45/38            |                 |
| Fan motor                     | Type                    |                   | Low noise 4-speed fan motor        |                             |                     |                     |                 |
|                               | Quantity                |                   | 1                                  |                             |                     |                     |                 |
| Fan                           | Type                    |                   | Centrifugal, forward-curved Blades |                             |                     |                     |                 |
|                               | Quantity                |                   | 1                                  | 1                           | 1                   | 1                   |                 |
| Coil                          | Row                     |                   | 2                                  | 3                           | 3                   | 4                   |                 |
|                               | Max. Working pressure   |                   | MPa                                | 1.6                         |                     |                     |                 |
|                               | Diameter                |                   | mm                                 | Φ9.52                       |                     |                     |                 |
| Body                          | Dimensions (*E)         | W×H×D             | mm                                 | 946×400×816 / 946×400×876   |                     |                     |                 |
|                               | Net weight (*E)         |                   | kg                                 | 50/53                       | 52/55               | 52/55               | 54/57           |
|                               | Packing (*E)            | W×H×D             | mm                                 | 1015×480×857 / 1015×480×925 |                     |                     |                 |
|                               | Gross weight (*E)       |                   | kg                                 | 55/58                       | 57/60               | 57/60               | 59/62           |
| Pipe connection               | Water inlet/outlet pipe |                   | inch                               | RC3/4"                      |                     |                     |                 |
|                               | Drain pipe              |                   | mm                                 | ODΦ32                       |                     |                     |                 |

### Note:

1. H: high speed; M: medium speed; L: low speed
2. The data is the performance in 70Pa external static pressure.
3. Cooling Conditions: Entering Water 7°C, Temperature Rise 5°C, Entering Air Temperature 27°C DB, 19°C WB.  
Heating Conditions: Entering Water 50°C, Entering air temperature 20°C, the same water flow as the cooling conditions.
4. Noise is tested in semi-anechoic test room.
5. \* for models without EAH; E for models with EAH

## Specifications

|                               |                         |                   |                                    |                             |                       |                  |
|-------------------------------|-------------------------|-------------------|------------------------------------|-----------------------------|-----------------------|------------------|
| Model MDKT3H-                 |                         |                   | 1600G100<br>1600EG100              | 1800G100<br>1800EG100       | 2200G100<br>2200EG100 |                  |
| Air flow                      | H/M/L                   | m <sup>3</sup> /h | 2720/2450/2170                     | 3060/2750/2450              | 3740/3360/2990        |                  |
|                               | H/M/L                   | CFM               | 1600/1440/1280                     | 1800/1620/1440              | 2200/1980/1760        |                  |
| External Static pressure      |                         | Pa                | 100                                |                             |                       |                  |
| Cooling                       | Capacity                | H/M/L             | kW                                 | 14.1/13.03/11.87            | 15.8/14.6/13.46       | 19.9/18.58/17.24 |
|                               | Water flow rate         | H                 | L/h                                | 2425                        | 2718                  | 3423             |
|                               | Water pressure drop     | H                 | kPa                                | 60                          | 78                    | 110              |
| Heating                       | Capacity                | H/M/L             | kW                                 | 21.2/18.23/15.69            | 23.8/20.94/17.85      | 30/26.7/22.5     |
|                               | Water pressure drop     | H                 | kPa                                | 57                          | 74                    | 105              |
| Power supply                  |                         | V/Ph/Hz           | 220-240/1/50                       |                             |                       |                  |
| Power input                   | H                       | W                 | 550                                | 800                         | 950                   |                  |
| Current input                 | H                       | A                 | 2.5                                | 3.66                        | 4.34                  |                  |
| Electric heater capacity (*E) |                         | W                 | 9500                               | 9500                        | 9500                  |                  |
| Sound pressure level          | H/M/L                   | dB(A)             | 54/47/40                           | 60/53/46                    | 61/54/47              |                  |
| Fan motor                     | Type                    |                   | Low noise 4-speed fan motor        |                             |                       |                  |
|                               | Quantity                |                   | 1                                  |                             |                       |                  |
| Fan                           | Type                    |                   | Centrifugal, forward-curved Blades |                             |                       |                  |
|                               | Quantity                |                   | 2                                  | 2                           | 2                     |                  |
| Coil                          | Row                     |                   | 3                                  | 3                           | 3                     |                  |
|                               | Max. Working pressure   |                   | MPa                                | 1.6                         |                       |                  |
|                               | Diameter                |                   | mm                                 | Φ9.52                       |                       |                  |
| Body                          | Dimensions (*E)         | W×H×D             | mm                                 | 1290×400×809 / 1290×400×874 |                       |                  |
|                               | Net weight (*E)         |                   | kg                                 | 76/82                       |                       |                  |
|                               | Packing (*E)            | W×H×D             | mm                                 | 1368×460×877 / 1368×460×950 |                       |                  |
|                               | Gross weight (*E)       |                   | kg                                 | 83/89                       |                       |                  |
| Pipe connection               | Water inlet/outlet pipe |                   | inch                               | RC3/4"                      |                       |                  |
|                               | Drain pipe              |                   | mm                                 | ODΦ32                       |                       |                  |

**Note:**

1. H: high speed; M: medium speed; L: low speed
2. The data is the performance in 70Pa external static pressure.
3. Cooling Conditions: Entering Water 7°C, Temperature Rise 5°C, Entering Air Temperature 27°C DB, 19°C WB.  
Heating Conditions: Entering Water 50°C, Entering air temperature 20°C, the same water flow as the cooling conditions.
4. Noise is tested in semi-anechoic test room.
5. \* for models without EAH; E for models with EAH

7. Dimension

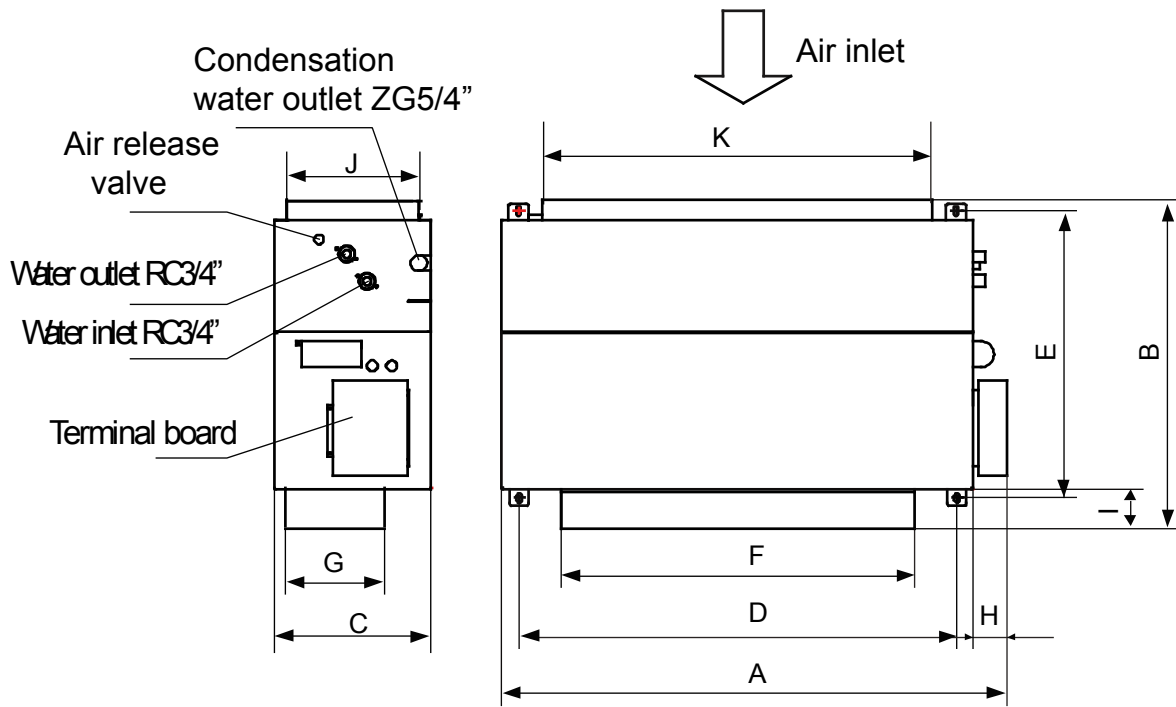

| Size \ Model | MDKT3H-800G70<br>MDKT3H-1000G70<br>MDKT3H-1200G70<br>MDKT3H-1400G70 | MDKT3H-800EG70<br>MDKT3H-1000EG70<br>MDKT3H-1200EG70<br>MDKT3H-1400EG70 | MDKT3H-1600G70<br>MDKT3H-1800G70<br>MDKT3H-2200G100 | MDKT3H-1600EG70<br>MDKT3H-1800EG70<br>MDKT3H-2200EG100 |
|--------------|---|---|---|--|
| A            | 946   | 946   | 1290  | 1290   |
| B            | 816   | 876   | 809   | 874  |
| C            | 400   | 400   | 400   | 400  |
| D            | 778   | 778   | 1118  | 1118   |
| E            | 767   | 767   | 765   | 765  |
| F            | 306   | 306   | 900   | 900  |
| G            | 219   | 219   | 249   | 249  |
| H            | 88  | 88  | 88  | 88   |
| I            | 37  | 97  | 39  | 104  |
| J            | 338   | 338   | 320   | 320  |
| K            | 512   | 512   | 995   | 995  |

### 8. Wiring Diagrams

For all models without auxiliary electrical heater:

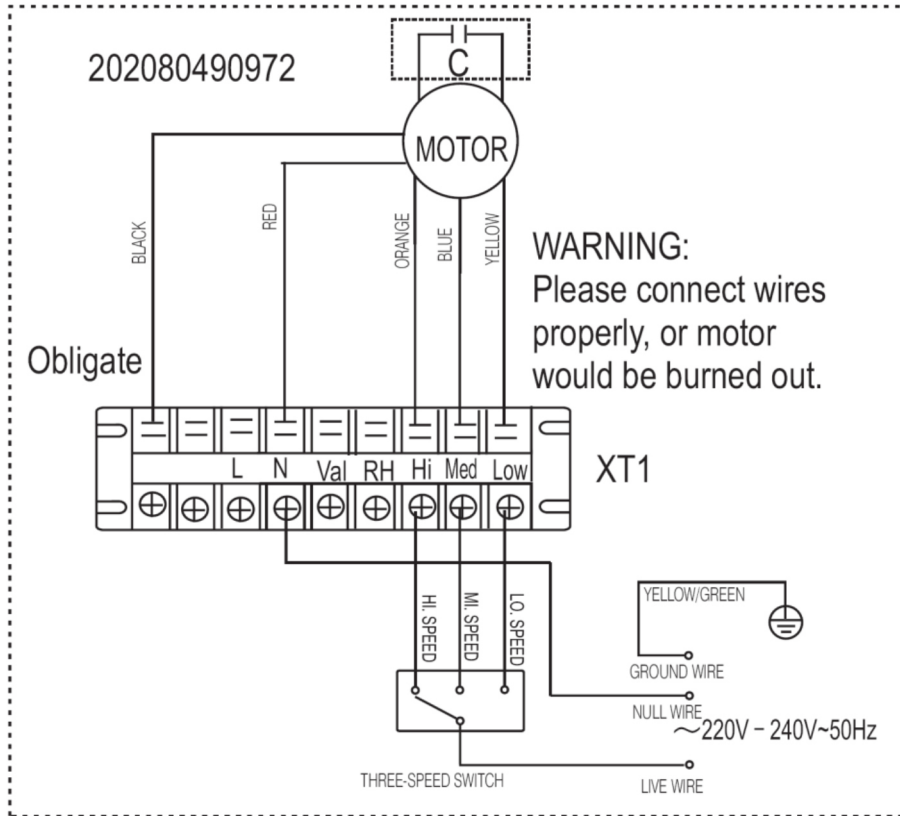

For all models with auxiliary electrical heater:

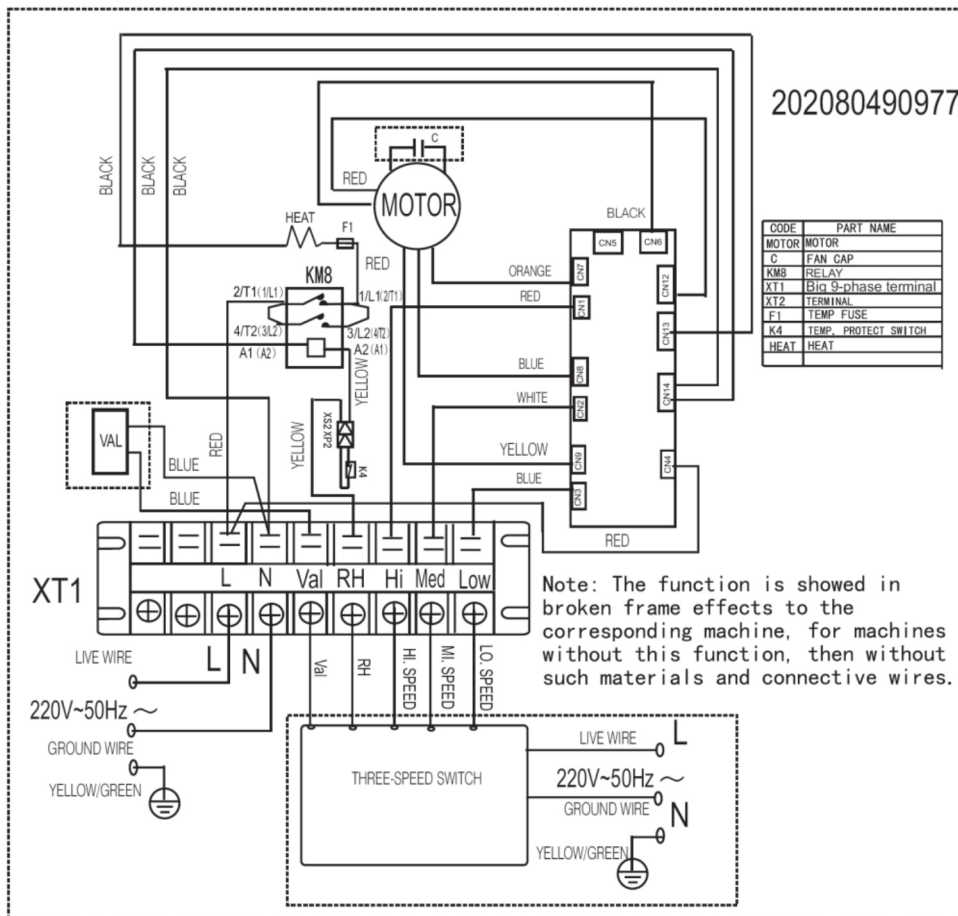



### 9. Capacity Tables

#### Cooling Capacity:

**Remark:** **EWT:** Enter Water Temp. (°C); **Δt:** Temperature Difference (°C)  
**DB:** Dry Bulb Temp. (°C); **WB:** Wet Bulb Temp. (°C);  
**TC:** Total Cooling Capacity (kW); **SC:** Sensible Cooling Capacity (kW);  
**WF:** Water Flow (m<sup>3</sup>/h); **WPD:** Water Pressure Drop (kPa)

| MDKT3H-800G70 |    |                     |      |      |      |             |      |      |      |             |      |      |      |             |      |      |      |             |      |      |      |
|---------------|----|---------------------|------|------|------|-------------|------|------|------|-------------|------|------|------|-------------|------|------|------|-------------|------|------|------|
| EWT           | Δt | Air inlet condition |      |      |      |             |      |      |      |             |      |      |      |             |      |      |      |             |      |      |      |
|               |    | DB:26.7 WB:19.4     |      |      |      | DB:27 WB:18 |      |      |      | DB:27 WB:19 |      |      |      | DB:27 WB:20 |      |      |      | DB:29 WB:21 |      |      |      |
|               |    | TC                  | SC   | WF   | WPD  | TC          | SC   | WF   | WPD  | TC          | SC   | WF   | WPD  | TC          | SC   | WF   | WPD  | TC          | SC   | WF   | WPD  |
| 5             | 3  | 8.41                | 5.07 | 2.41 | 36.1 | 7.71        | 5.57 | 2.21 | 30.4 | 8.24        | 5.29 | 2.36 | 34.6 | 8.71        | 5.06 | 2.5  | 38.7 | 9.2         | 4.83 | 2.64 | 43.2 |
|               | 4  | 8.09                | 4.91 | 1.74 | 18.8 | 7.43        | 5.4  | 1.6  | 15.8 | 7.95        | 5.13 | 1.71 | 18.2 | 8.42        | 4.91 | 1.81 | 20.3 | 8.84        | 4.67 | 1.9  | 22.4 |
|               | 5  | 7.73                | 4.74 | 1.33 | 11.0 | 7.08        | 5.28 | 1.22 | 9.2  | 7.58        | 4.97 | 1.3  | 10.6 | 8.09        | 4.73 | 1.39 | 12.0 | 8.5         | 7.34 | 1.46 | 13.3 |
|               | 6  | 7.39                | 4.61 | 1.06 | 7.0  | 6.73        | 5.1  | 0.97 | 5.8  | 7.25        | 4.8  | 1.04 | 6.7  | 7.75        | 4.55 | 1.11 | 7.7  | 8.12        | 4.32 | 1.16 | 8.4  |
|               | 7  | 7.03                | 4.39 | 0.86 | 4.6  | 6.36        | 4.97 | 0.78 | 3.8  | 6.87        | 4.64 | 0.84 | 4.4  | 7.37        | 4.39 | 0.91 | 5.1  | 7.78        | 4.15 | 0.96 | 5.7  |
| 6             | 3  | 7.93                | 4.87 | 2.27 | 32.1 | 7.23        | 5.36 | 2.07 | 26.7 | 7.75        | 5.08 | 2.22 | 30.7 | 8.26        | 4.84 | 2.37 | 34.8 | 8.73        | 4.61 | 2.5  | 38.9 |
|               | 4  | 7.62                | 4.7  | 1.64 | 16.7 | 6.9         | 5.19 | 1.48 | 13.7 | 7.44        | 4.9  | 1.6  | 15.9 | 7.93        | 4.69 | 1.71 | 18.1 | 8.38        | 4.46 | 1.8  | 20.2 |
|               | 5  | 7.25                | 4.52 | 1.25 | 9.7  | 6.59        | 5.05 | 1.13 | 8.0  | 7.1         | 4.76 | 1.22 | 9.3  | 7.57        | 4.49 | 1.3  | 10.5 | 8.05        | 4.29 | 1.38 | 11.9 |
|               | 6  | 6.9                 | 4.39 | 0.99 | 6.1  | 6.25        | 4.88 | 0.9  | 5.0  | 6.74        | 4.58 | 0.97 | 5.8  | 7.25        | 4.31 | 1.04 | 6.7  | 7.65        | 4.1  | 1.1  | 7.5  |
|               | 7  | 6.54                | 4.19 | 0.8  | 4.0  | 5.86        | 4.75 | 0.72 | 3.2  | 6.38        | 4.46 | 0.78 | 3.8  | 6.84        | 4.17 | 0.84 | 4.4  | 7.3         | 3.92 | 0.9  | 5.0  |
| 7             | 3  | 7.41                | 4.63 | 2.12 | 28.0 | 6.72        | 5.15 | 1.93 | 23.1 | 7.25        | 4.87 | 2.08 | 26.8 | 7.78        | 4.62 | 2.23 | 30.9 | 8.22        | 4.38 | 2.36 | 34.5 |
|               | 4  | 7.1                 | 4.47 | 1.53 | 14.5 | 6.37        | 5.04 | 1.37 | 11.7 | 6.91        | 4.7  | 1.49 | 13.7 | 7.43        | 4.47 | 1.6  | 15.8 | 7.9         | 4.24 | 1.7  | 17.9 |
|               | 5  | 6.74                | 4.3  | 1.16 | 8.4  | 6.05        | 4.88 | 1.04 | 6.7  | 6.6         | 4.54 | 1.14 | 8.0  | 7.08        | 4.27 | 1.22 | 9.2  | 7.51        | 4.07 | 1.29 | 10.4 |
|               | 6  | 6.39                | 4.18 | 0.92 | 5.2  | 5.7         | 4.72 | 0.82 | 4.1  | 6.28        | 4.38 | 0.9  | 5.0  | 6.75        | 4.1  | 0.97 | 5.8  | 7.17        | 3.89 | 1.03 | 6.6  |
|               | 7  | 6.05                | 3.99 | 0.74 | 3.4  | 5.31        | 4.55 | 0.65 | 2.7  | 5.85        | 4.25 | 0.72 | 3.2  | 6.35        | 3.97 | 0.78 | 3.8  | 6.79        | 3.72 | 0.83 | 4.3  |
| 8             | 3  | 6.9                 | 4.43 | 1.98 | 24.3 | 6.16        | 4.97 | 1.77 | 19.4 | 6.74        | 4.64 | 1.93 | 23.2 | 7.26        | 4.38 | 2.08 | 26.9 | 7.72        | 4.14 | 2.21 | 30.4 |
|               | 4  | 6.6                 | 4.28 | 1.42 | 12.5 | 5.86        | 4.81 | 1.26 | 9.8  | 6.4         | 4.53 | 1.38 | 11.8 | 6.9         | 4.24 | 1.48 | 13.7 | 7.35        | 4.02 | 1.58 | 15.5 |
|               | 5  | 6.27                | 4.1  | 1.08 | 7.2  | 5.5         | 4.67 | 0.95 | 5.6  | 6.08        | 4.34 | 1.05 | 6.8  | 6.59        | 4.09 | 1.13 | 8.0  | 7.04        | 3.86 | 1.21 | 9.1  |
|               | 6  | 5.86                | 3.97 | 0.84 | 4.4  | 5.14        | 4.54 | 0.74 | 3.4  | 5.74        | 4.19 | 0.82 | 4.2  | 6.25        | 3.9  | 0.9  | 5.0  | 6.69        | 3.68 | 0.96 | 5.7  |
|               | 7  | 5.51                | 3.79 | 0.68 | 2.9  | 4.77        | 4.35 | 0.59 | 2.1  | 5.34        | 4.05 | 0.66 | 2.7  | 5.85        | 3.75 | 0.72 | 3.2  | 6.26        | 3.52 | 0.77 | 3.7  |
| 9             | 3  | 6.42                | 4.23 | 1.84 | 21.0 | 5.65        | 4.78 | 1.62 | 16.3 | 6.24        | 4.44 | 1.79 | 19.9 | 6.77        | 4.16 | 1.94 | 23.4 | 7.21        | 3.94 | 2.07 | 26.5 |
|               | 4  | 6.06                | 4.08 | 1.3  | 10.5 | 5.31        | 4.64 | 1.14 | 8.1  | 5.88        | 4.3  | 1.26 | 9.9  | 6.38        | 4.05 | 1.37 | 11.7 | 6.84        | 3.8  | 1.47 | 13.4 |
|               | 5  | 5.73                | 3.9  | 0.99 | 6.0  | 4.91        | 4.53 | 0.85 | 4.4  | 5.55        | 4.16 | 0.96 | 5.7  | 6.05        | 3.88 | 1.04 | 6.7  | 6.5         | 3.63 | 1.12 | 7.8  |
|               | 6  | 5.35                | 3.76 | 0.77 | 3.7  | 4.54        | 4.39 | 0.65 | 2.6  | 5.16        | 4.03 | 0.74 | 3.4  | 5.71        | 3.7  | 0.82 | 4.2  | 6.16        | 3.46 | 0.88 | 4.8  |
|               | 7  | 4.95                | 3.58 | 0.61 | 2.3  | 4.24        | /    | 0.52 | 1.7  | 4.78        | 3.85 | 0.59 | 2.1  | 5.3         | 3.58 | 0.65 | 2.6  | 5.73        | 3.3  | 0.7  | 3.1  |
| 10            | 3  | 5.89                | 4.01 | 1.69 | 17.7 | 5.07        | 4.6  | 1.45 | 13.1 | 5.65        | 4.28 | 1.62 | 16.3 | 6.22        | 3.99 | 1.78 | 19.7 | 6.7         | 3.73 | 1.92 | 22.9 |
|               | 4  | 5.52                | 3.86 | 1.19 | 8.8  | 4.69        | 4.5  | 1.01 | 6.3  | 5.33        | 4.13 | 1.15 | 8.2  | 5.88        | 3.84 | 1.26 | 9.9  | 6.31        | 3.59 | 1.36 | 11.4 |
|               | 5  | 5.16                | 3.73 | 0.89 | 4.9  | 4.39        | /    | 0.76 | 3.5  | 4.94        | 4    | 0.85 | 4.5  | 5.5         | 3.69 | 0.95 | 5.6  | 5.98        | 3.43 | 1.03 | 6.6  |
|               | 6  | 4.81                | 3.57 | 0.69 | 3.0  | 4.16        | /    | 0.6  | 2.2  | 4.59        | 3.85 | 0.66 | 2.7  | 5.14        | 3.49 | 0.74 | 3.4  | 5.59        | 3.26 | 0.8  | 4.0  |
|               | 7  | 4.39                | 3.42 | 0.54 | 1.8  | 3.91        | /    | 0.48 | 1.4  | 4.18        | 3.7  | 0.51 | 1.6  | 4.71        | 3.38 | 0.58 | 2.1  | 5.23        | 3.1  | 0.64 | 2.6  |
| 11            | 3  | 5.31                | 3.83 | 1.52 | 14.4 | 4.5         | /    | 1.29 | 10.4 | 5.12        | 4.08 | 1.47 | 13.4 | 5.66        | 3.81 | 1.62 | 16.3 | 6.16        | 3.53 | 1.77 | 19.4 |
|               | 4  | 4.98                | 3.7  | 1.07 | 7.1  | 4.29        | /    | 0.92 | 5.3  | 4.78        | 3.92 | 1.03 | 6.6  | 5.32        | 3.63 | 1.14 | 8.1  | 5.82        | 3.39 | 1.25 | 9.7  |
|               | 5  | 4.6                 | 3.55 | 0.79 | 3.9  | 4.08        | /    | 0.7  | 3.1  | 4.39        | 3.83 | 0.76 | 3.5  | 4.95        | 3.48 | 0.85 | 4.5  | 5.44        | 3.23 | 0.94 | 5.4  |
|               | 6  | 4.19                | 3.41 | 0.6  | 2.2  | 3.82        | /    | 0.55 | 1.9  | 4.03        | 3.66 | 0.58 | 2.1  | 4.57        | 3.36 | 0.66 | 2.7  | 5.05        | 3.07 | 0.72 | 3.3  |
|               | 7  | 3.73                | 3.29 | 0.46 | 1.3  | 3.6         | /    | 0.44 | 1.2  | 3.6         | /    | 0.44 | 1.2  | 4.14        | 3.19 | 0.51 | 1.6  | 4.65        | 2.89 | 0.57 | 2.0  |
| 12            | 3  | 4.75                | 3.65 | 1.36 | 11.5 | 4.17        | /    | 1.2  | 8.9  | 4.52        | 3.93 | 1.3  | 10.4 | 5.12        | 3.59 | 1.47 | 13.4 | 5.6         | 3.34 | 1.61 | 16.0 |
|               | 4  | 4.4                 | 3.52 | 0.95 | 5.6  | 3.97        | /    | 0.85 | 4.5  | 4.18        | 3.8  | 0.9  | 5.0  | 4.76        | 3.46 | 1.02 | 6.5  | 5.27        | 3.19 | 1.13 | 8.0  |
|               | 5  | 4.02                | 3.4  | 0.69 | 3.0  | 3.8         | /    | 0.65 | 2.7  | 3.81        | 3.68 | 0.66 | 2.7  | 4.39        | 3.33 | 0.76 | 3.5  | 4.89        | 3.05 | 0.84 | 4.4  |
|               | 6  | 3.57                | 3.29 | 0.51 | 1.6  | 3.53        | /    | 0.51 | 1.6  | 3.53        | 3.47 | 0.51 | 1.6  | 3.98        | 3.19 | 0.57 | 2.0  | 4.48        | 2.88 | 0.64 | 2.6  |
|               | 7  | 3.16                | /    | 0.39 | 0.9  | 3.29        | /    | 0.4  | 1.0  | 3.26        | /    | 0.4  | 1.0  | 3.48        | 3.03 | 0.43 | 1.1  | 4.07        | 2.7  | 0.5  | 1.6  |
| 13            | 3  | 4.15                | 3.49 | 1.19 | 8.8  | 3.85        | /    | 1.1  | 7.6  | 3.91        | 3.78 | 1.12 | 7.8  | 4.51        | 3.42 | 1.29 | 10.4 | 5.05        | 3.15 | 1.45 | 13.0 |
|               | 4  | 3.8                 | 3.35 | 0.82 | 4.1  | 3.67        | /    | 0.79 | 3.9  | 3.67        | 3.6  | 0.79 | 3.9  | 4.15        | 3.33 | 0.89 | 5.0  | 4.69        | 3    | 1.01 | 6.3  |
|               | 5  | 3.39                | 3.31 | 0.58 | 2.1  | 3.42        | /    | 0.59 | 2.2  | 3.43        | /    | 0.59 | 2.2  | 3.79        | 3.17 | 0.65 | 2.6  | 4.31        | 2.86 | 0.74 | 3.4  |
|               | 6  | 3.09                | /    | 0.44 | 1.2  | 3.19        | /    | 0.46 | 1.3  | 3.19        | /    | 0.46 | 1.3  | 3.34        | 3.06 | 0.48 | 1.4  | 3.9         | 2.7  | 0.56 | 1.9  |
|               | 7  | 2.82                | /    | 0.35 | 0.7  | 2.92        | /    | 0.36 | 0.8  | 2.93        | /    | 0.36 | 0.8  | 2.93        | 2.87 | 0.36 | 0.8  | 3.41        | 2.55 | 0.42 | 1.1  |

Cooling capacity

| MDKT3H-1000G70 |    |                     |      |      |       |             |      |      |      |             |      |      |       |             |      |      |       |             |      |      |       |
|----------------|----|---------------------|------|------|-------|-------------|------|------|------|-------------|------|------|-------|-------------|------|------|-------|-------------|------|------|-------|
| EWT            | Δt | Air inlet condition |      |      |       |             |      |      |      |             |      |      |       |             |      |      |       |             |      |      |       |
|                |    | DB:26.7 WB:19.4     |      |      |       | DB:27 WB:18 |      |      |      | DB:27 WB:19 |      |      |       | DB:27 WB:20 |      |      |       | DB:29 WB:21 |      |      |       |
|                |    | TC                  | SC   | WF   | WPD   | TC          | SC   | WF   | WPD  | TC          | SC   | WF   | WPD   | TC          | SC   | WF   | WPD   | TC          | SC   | WF   | WPD   |
| 5              | 3  | 11.21               | 6.76 | 3.21 | 108.2 | 10.29       | 7.43 | 2.95 | 91.1 | 10.98       | 7.05 | 3.15 | 103.9 | 11.62       | 6.74 | 3.33 | 116.2 | 12.27       | 6.44 | 3.52 | 129.5 |
|                | 4  | 10.78               | 6.55 | 2.32 | 56.3  | 9.9         | 7.2  | 2.13 | 47.5 | 10.6        | 6.84 | 2.28 | 54.4  | 11.23       | 6.55 | 2.41 | 61.0  | 11.78       | 6.22 | 2.53 | 67.3  |
|                | 5  | 10.31               | 6.32 | 1.77 | 33.0  | 9.43        | 7.03 | 1.62 | 27.6 | 10.11       | 6.63 | 1.74 | 31.7  | 10.78       | 6.31 | 1.85 | 36.0  | 11.33       | 9.79 | 1.95 | 39.8  |
|                | 6  | 9.85                | 6.15 | 1.41 | 20.9  | 8.98        | 6.79 | 1.29 | 17.4 | 9.66        | 6.4  | 1.39 | 20.1  | 10.34       | 6.07 | 1.48 | 23.0  | 10.83       | 5.77 | 1.55 | 25.3  |
|                | 7  | 9.37                | 5.85 | 1.15 | 13.9  | 8.48        | 6.63 | 1.04 | 11.4 | 9.16        | 6.18 | 1.12 | 13.3  | 9.83        | 5.85 | 1.21 | 15.3  | 10.37       | 5.54 | 1.27 | 17.0  |
| 6              | 3  | 10.58               | 6.49 | 3.03 | 96.3  | 9.64        | 7.15 | 2.76 | 80.0 | 10.34       | 6.77 | 2.96 | 92.0  | 11.01       | 6.45 | 3.16 | 104.4 | 11.64       | 6.15 | 3.34 | 116.7 |
|                | 4  | 10.16               | 6.26 | 2.18 | 50.0  | 9.21        | 6.92 | 1.98 | 41.0 | 9.92        | 6.54 | 2.13 | 47.6  | 10.58       | 6.25 | 2.27 | 54.2  | 11.17       | 5.94 | 2.4  | 60.5  |
|                | 5  | 9.66                | 6.03 | 1.66 | 28.9  | 8.79        | 6.73 | 1.51 | 23.9 | 9.47        | 6.35 | 1.63 | 27.8  | 10.1        | 5.98 | 1.74 | 31.6  | 10.73       | 5.71 | 1.85 | 35.7  |
|                | 6  | 9.21                | 5.85 | 1.32 | 18.2  | 8.33        | 6.5  | 1.19 | 14.9 | 8.99        | 6.11 | 1.29 | 17.4  | 9.66        | 5.75 | 1.39 | 20.1  | 10.2        | 5.46 | 1.46 | 22.4  |
|                | 7  | 8.72                | 5.59 | 1.07 | 12.0  | 7.81        | 6.34 | 0.96 | 9.6  | 8.51        | 5.94 | 1.05 | 11.5  | 9.12        | 5.56 | 1.12 | 13.1  | 9.74        | 5.23 | 1.2  | 15.0  |
| 7              | 3  | 9.88                | 6.17 | 2.83 | 84.0  | 8.97        | 6.87 | 2.57 | 69.2 | 9.66        | 6.49 | 2.77 | 80.4  | 10.37       | 6.16 | 2.97 | 92.7  | 10.96       | 5.84 | 3.14 | 103.4 |
|                | 4  | 9.47                | 5.96 | 2.04 | 43.5  | 8.5         | 6.72 | 1.83 | 35.0 | 9.22        | 6.27 | 1.98 | 41.2  | 9.9         | 5.96 | 2.13 | 47.5  | 10.53       | 5.65 | 2.26 | 53.7  |
|                | 5  | 8.99                | 5.74 | 1.55 | 25.1  | 8.06        | 6.5  | 1.39 | 20.2 | 8.8         | 6.06 | 1.51 | 24.0  | 9.43        | 5.69 | 1.62 | 27.6  | 10.02       | 5.42 | 1.72 | 31.1  |
|                | 6  | 8.52                | 5.57 | 1.22 | 15.6  | 7.59        | 6.3  | 1.09 | 12.4 | 8.37        | 5.84 | 1.2  | 15.1  | 9           | 5.47 | 1.29 | 17.5  | 9.56        | 5.18 | 1.37 | 19.7  |
|                | 7  | 8.06                | 5.32 | 0.99 | 10.3  | 7.09        | 6.07 | 0.87 | 7.9  | 7.8         | 5.66 | 0.96 | 9.6   | 8.47        | 5.3  | 1.04 | 11.3  | 9.05        | 4.97 | 1.11 | 13.0  |
| 8              | 3  | 9.21                | 5.9  | 2.64 | 73.0  | 8.22        | 6.63 | 2.36 | 58.1 | 8.99        | 6.18 | 2.58 | 69.6  | 9.68        | 5.84 | 2.77 | 80.6  | 10.3        | 5.52 | 2.95 | 91.3  |
|                | 4  | 8.8                 | 5.7  | 1.89 | 37.5  | 7.81        | 6.41 | 1.68 | 29.5 | 8.53        | 6.04 | 1.83 | 35.3  | 9.21        | 5.65 | 1.98 | 41.0  | 9.8         | 5.36 | 2.11 | 46.5  |
|                | 5  | 8.36                | 5.46 | 1.44 | 21.6  | 7.33        | 6.22 | 1.26 | 16.6 | 8.1         | 5.79 | 1.39 | 20.3  | 8.79        | 5.45 | 1.51 | 23.9  | 9.38        | 5.14 | 1.61 | 27.3  |
|                | 6  | 7.81                | 5.3  | 1.12 | 13.1  | 6.86        | 6.06 | 0.98 | 10.1 | 7.66        | 5.59 | 1.1  | 12.6  | 8.33        | 5.21 | 1.19 | 14.9  | 8.91        | 4.9  | 1.28 | 17.1  |
|                | 7  | 7.35                | 5.05 | 0.9  | 8.6   | 6.36        | 5.8  | 0.78 | 6.4  | 7.12        | 5.4  | 0.88 | 8.0   | 7.8         | 5    | 0.96 | 9.6   | 8.34        | 4.7  | 1.02 | 11.0  |
| 9              | 3  | 8.56                | 5.64 | 2.45 | 63.1  | 7.53        | 6.37 | 2.16 | 48.8 | 8.32        | 5.92 | 2.38 | 59.6  | 9.03        | 5.55 | 2.59 | 70.2  | 9.61        | 5.26 | 2.76 | 79.6  |
|                | 4  | 8.08                | 5.43 | 1.74 | 31.6  | 7.09        | 6.18 | 1.52 | 24.3 | 7.83        | 5.74 | 1.68 | 29.7  | 8.51        | 5.4  | 1.83 | 35.1  | 9.12        | 5.07 | 1.96 | 40.3  |
|                | 5  | 7.64                | 5.21 | 1.31 | 18.1  | 6.55        | 6.04 | 1.13 | 13.3 | 7.4         | 5.55 | 1.27 | 17.0  | 8.06        | 5.17 | 1.39 | 20.2  | 8.67        | 4.84 | 1.49 | 23.3  |
|                | 6  | 7.14                | 5.02 | 1.02 | 11.0  | 6.06        | 5.85 | 0.87 | 7.9  | 6.88        | 5.37 | 0.99 | 10.2  | 7.62        | 4.93 | 1.09 | 12.5  | 8.22        | 4.61 | 1.18 | 14.5  |
|                | 7  | 6.6                 | 4.77 | 0.81 | 6.9   | 5.65        | /    | 0.69 | 5.1  | 6.37        | 5.13 | 0.78 | 6.4   | 7.06        | 4.77 | 0.87 | 7.9   | 7.64        | 4.41 | 0.94 | 9.2   |
| 10             | 3  | 7.85                | 5.35 | 2.25 | 53.0  | 6.76        | 6.13 | 1.94 | 39.3 | 7.53        | 5.7  | 2.16 | 48.8  | 8.29        | 5.32 | 2.38 | 59.2  | 8.94        | 4.98 | 2.56 | 68.8  |
|                | 4  | 7.37                | 5.14 | 1.58 | 26.3  | 6.25        | 6.01 | 1.34 | 18.9 | 7.11        | 5.51 | 1.53 | 24.5  | 7.83        | 5.12 | 1.68 | 29.7  | 8.42        | 4.79 | 1.81 | 34.3  |
|                | 5  | 6.88                | 4.98 | 1.18 | 14.7  | 5.85        | /    | 1.01 | 10.6 | 6.59        | 5.33 | 1.13 | 13.5  | 7.34        | 4.91 | 1.26 | 16.7  | 7.97        | 4.57 | 1.37 | 19.7  |
|                | 6  | 6.41                | 4.76 | 0.92 | 8.9   | 5.55        | /    | 0.8  | 6.6  | 6.12        | 5.13 | 0.88 | 8.1   | 6.86        | 4.65 | 0.98 | 10.1  | 7.45        | 4.34 | 1.07 | 12.0  |
|                | 7  | 5.85                | 4.56 | 0.72 | 5.4   | 5.22        | /    | 0.64 | 4.3  | 5.57        | 4.94 | 0.68 | 4.9   | 6.29        | 4.51 | 0.77 | 6.3   | 6.97        | 4.13 | 0.86 | 7.7   |
| 11             | 3  | 7.09                | 5.1  | 2.03 | 43.2  | 6.01        | /    | 1.72 | 31.1 | 6.83        | 5.43 | 1.96 | 40.2  | 7.54        | 5.08 | 2.16 | 49.0  | 8.22        | 4.71 | 2.36 | 58.1  |
|                | 4  | 6.64                | 4.93 | 1.43 | 21.4  | 5.71        | /    | 1.23 | 15.8 | 6.37        | 5.23 | 1.37 | 19.7  | 7.1         | 4.84 | 1.53 | 24.4  | 7.76        | 4.52 | 1.67 | 29.2  |
|                | 5  | 6.13                | 4.74 | 1.05 | 11.7  | 5.43        | /    | 0.93 | 9.2  | 5.85        | 5.1  | 1.01 | 10.6  | 6.6         | 4.63 | 1.14 | 13.5  | 7.25        | 4.3  | 1.25 | 16.3  |
|                | 6  | 5.59                | 4.55 | 0.8  | 6.7   | 5.09        | /    | 0.73 | 5.6  | 5.37        | 4.88 | 0.77 | 6.2   | 6.1         | 4.48 | 0.87 | 8.0   | 6.73        | 4.09 | 0.96 | 9.8   |
|                | 7  | 4.98                | 4.38 | 0.61 | 3.9   | 4.8         | /    | 0.59 | 3.6  | 4.8         | /    | 0.59 | 3.6   | 5.52        | 4.25 | 0.68 | 4.8   | 6.2         | 3.85 | 0.76 | 6.1   |
| 12             | 3  | 6.34                | 4.86 | 1.82 | 34.6  | 5.56        | /    | 1.59 | 26.6 | 6.03        | 5.24 | 1.73 | 31.3  | 6.83        | 4.79 | 1.96 | 40.2  | 7.47        | 4.46 | 2.14 | 48.0  |
|                | 4  | 5.87                | 4.7  | 1.26 | 16.7  | 5.3         | /    | 1.14 | 13.6 | 5.57        | 5.07 | 1.2  | 15.1  | 6.35        | 4.61 | 1.37 | 19.5  | 7.02        | 4.25 | 1.51 | 23.9  |
|                | 5  | 5.36                | 4.53 | 0.92 | 8.9   | 5.07        | /    | 0.87 | 8.0  | 5.08        | 4.9  | 0.87 | 8.0   | 5.85        | 4.44 | 1.01 | 10.6  | 6.51        | 4.06 | 1.12 | 13.2  |
|                | 6  | 4.76                | 4.38 | 0.68 | 4.9   | 4.71        | /    | 0.68 | 4.8  | 4.71        | 4.62 | 0.68 | 4.8   | 5.31        | 4.25 | 0.76 | 6.1   | 5.97        | 3.83 | 0.86 | 7.7   |
|                | 7  | 4.22                | /    | 0.52 | 2.8   | 4.38        | /    | 0.54 | 3.0  | 4.34        | /    | 0.53 | 3.0   | 4.63        | 4.04 | 0.57 | 3.4   | 5.42        | 3.61 | 0.67 | 4.7   |
| 13             | 3  | 5.54                | 4.65 | 1.59 | 26.4  | 5.13        | /    | 1.47 | 22.7 | 5.22        | 5.04 | 1.5  | 23.5  | 6.02        | 4.56 | 1.73 | 31.2  | 6.73        | 4.2  | 1.93 | 39.0  |
|                | 4  | 5.07                | 4.47 | 1.09 | 12.4  | 4.89        | /    | 1.05 | 11.6 | 4.89        | 4.8  | 1.05 | 11.6  | 5.54        | 4.44 | 1.19 | 14.8  | 6.25        | 4    | 1.34 | 18.9  |
|                | 5  | 4.52                | 4.42 | 0.78 | 6.3   | 4.56        | /    | 0.78 | 6.4  | 4.57        | /    | 0.79 | 6.5   | 5.05        | 4.23 | 0.87 | 7.9   | 5.75        | 3.81 | 0.99 | 10.3  |
|                | 6  | 4.11                | /    | 0.59 | 3.6   | 4.25        | /    | 0.61 | 3.9  | 4.25        | /    | 0.61 | 3.9   | 4.46        | 4.08 | 0.64 | 4.3   | 5.19        | 3.61 | 0.74 | 5.8   |
|                | 7  | 3.76                | /    | 0.46 | 2.2   | 3.9         | /    | 0.48 | 2.4  | 3.91        | /    | 0.48 | 2.4   | 3.91        | 3.82 | 0.48 | 2.4   | 4.55        | 3.4  | 0.56 | 3.3   |

Cooling capacity

| MDKT3H-1200G70 |    |                     |      |      |       |             |      |      |      |             |      |      |       |             |      |      |       |             |       |      |       |
|----------------|----|---------------------|------|------|-------|-------------|------|------|------|-------------|------|------|-------|-------------|------|------|-------|-------------|-------|------|-------|
| EWT            | Δt | Air inlet condition |      |      |       |             |      |      |      |             |      |      |       |             |      |      |       |             |       |      |       |
|                |    | DB:26.7 WB:19.4     |      |      |       | DB:27 WB:18 |      |      |      | DB:27 WB:19 |      |      |       | DB:27 WB:20 |      |      |       | DB:29 WB:21 |       |      |       |
|                |    | TC                  | SC   | WF   | WPD   | TC          | SC   | WF   | WPD  | TC          | SC   | WF   | WPD   | TC          | SC   | WF   | WPD   | TC          | SC    | WF   | WPD   |
| 5              | 3  | 12.74               | 7.68 | 3.65 | 108.2 | 11.69       | 8.44 | 3.35 | 91.1 | 12.48       | 8.01 | 3.58 | 103.9 | 13.2        | 7.66 | 3.78 | 116.2 | 13.94       | 7.32  | 4    | 129.5 |
|                | 4  | 12.25               | 7.45 | 2.63 | 56.3  | 11.26       | 8.18 | 2.42 | 47.5 | 12.05       | 7.78 | 2.59 | 54.4  | 12.76       | 7.45 | 2.74 | 61.0  | 13.39       | 7.07  | 2.88 | 67.3  |
|                | 5  | 11.72               | 7.19 | 2.02 | 33.0  | 10.72       | 7.99 | 1.84 | 27.6 | 11.49       | 7.53 | 1.98 | 31.7  | 12.25       | 7.17 | 2.11 | 36.0  | 12.87       | 11.13 | 2.21 | 39.8  |
|                | 6  | 11.2                | 6.98 | 1.61 | 20.9  | 10.2        | 7.72 | 1.46 | 17.4 | 10.98       | 7.27 | 1.57 | 20.1  | 11.75       | 6.9  | 1.68 | 23.0  | 12.31       | 6.55  | 1.76 | 25.3  |
|                | 7  | 10.65               | 6.65 | 1.31 | 13.9  | 9.64        | 7.53 | 1.18 | 11.4 | 10.4        | 7.03 | 1.28 | 13.3  | 11.17       | 6.65 | 1.37 | 15.3  | 11.79       | 6.29  | 1.45 | 17.0  |
| 6              | 3  | 12.02               | 7.37 | 3.45 | 96.3  | 10.95       | 8.12 | 3.14 | 80.0 | 11.75       | 7.69 | 3.37 | 92.0  | 12.51       | 7.33 | 3.59 | 104.4 | 13.23       | 6.98  | 3.79 | 116.7 |
|                | 4  | 11.54               | 7.11 | 2.48 | 50.0  | 10.46       | 7.86 | 2.25 | 41.0 | 11.27       | 7.43 | 2.42 | 47.6  | 12.02       | 7.1  | 2.58 | 54.2  | 12.7        | 6.75  | 2.73 | 60.5  |
|                | 5  | 10.98               | 6.85 | 1.89 | 28.9  | 9.99        | 7.65 | 1.72 | 23.9 | 10.76       | 7.22 | 1.85 | 27.8  | 11.47       | 6.8  | 1.97 | 31.6  | 12.19       | 6.49  | 2.1  | 35.7  |
|                | 6  | 10.46               | 6.65 | 1.5  | 18.2  | 9.47        | 7.39 | 1.36 | 14.9 | 10.22       | 6.94 | 1.46 | 17.4  | 10.98       | 6.54 | 1.57 | 20.1  | 11.59       | 6.2   | 1.66 | 22.4  |
|                | 7  | 9.91                | 6.35 | 1.22 | 12.0  | 8.87        | 7.2  | 1.09 | 9.6  | 9.67        | 6.75 | 1.19 | 11.5  | 10.36       | 6.32 | 1.27 | 13.1  | 11.07       | 5.95  | 1.36 | 15.0  |
| 7              | 3  | 11.23               | 7.01 | 3.22 | 84.0  | 10.19       | 7.81 | 2.92 | 69.2 | 10.98       | 7.37 | 3.15 | 80.4  | 11.79       | 7    | 3.38 | 92.7  | 12.45       | 6.64  | 3.57 | 103.4 |
|                | 4  | 10.76               | 6.77 | 2.31 | 43.5  | 9.65        | 7.63 | 2.08 | 35.0 | 10.48       | 7.13 | 2.25 | 41.2  | 11.26       | 6.77 | 2.42 | 47.5  | 11.96       | 6.42  | 2.57 | 53.7  |
|                | 5  | 10.22               | 6.52 | 1.76 | 25.1  | 9.16        | 7.39 | 1.58 | 20.2 | 10          | 6.88 | 1.72 | 24.0  | 10.72       | 6.46 | 1.84 | 27.6  | 11.39       | 6.16  | 1.96 | 31.1  |
|                | 6  | 9.68                | 6.33 | 1.39 | 15.6  | 8.63        | 7.16 | 1.24 | 12.4 | 9.51        | 6.64 | 1.36 | 15.1  | 10.23       | 6.22 | 1.47 | 17.5  | 10.87       | 5.89  | 1.56 | 19.7  |
|                | 7  | 9.16                | 6.05 | 1.13 | 10.3  | 8.05        | 6.9  | 0.99 | 7.9  | 8.86        | 6.44 | 1.09 | 9.6   | 9.62        | 6.02 | 1.18 | 11.3  | 10.29       | 5.64  | 1.26 | 13.0  |
| 8              | 3  | 10.46               | 6.71 | 3    | 73.0  | 9.34        | 7.53 | 2.68 | 58.1 | 10.22       | 7.03 | 2.93 | 69.6  | 11          | 6.64 | 3.15 | 80.6  | 11.7        | 6.28  | 3.35 | 91.3  |
|                | 4  | 10                  | 6.48 | 2.15 | 37.5  | 8.87        | 7.29 | 1.91 | 29.5 | 9.7         | 6.87 | 2.08 | 35.3  | 10.46       | 6.42 | 2.25 | 41.0  | 11.14       | 6.09  | 2.4  | 46.5  |
|                | 5  | 9.49                | 6.2  | 1.63 | 21.6  | 8.33        | 7.07 | 1.43 | 16.6 | 9.21        | 6.58 | 1.58 | 20.3  | 9.99        | 6.19 | 1.72 | 23.9  | 10.66       | 5.84  | 1.83 | 27.3  |
|                | 6  | 8.87                | 6.02 | 1.27 | 13.1  | 7.79        | 6.88 | 1.12 | 10.1 | 8.7         | 6.35 | 1.25 | 12.6  | 9.47        | 5.92 | 1.36 | 14.9  | 10.13       | 5.57  | 1.45 | 17.1  |
|                | 7  | 8.35                | 5.74 | 1.03 | 8.6   | 7.23        | 6.59 | 0.89 | 6.4  | 8.1         | 6.13 | 0.99 | 8.0   | 8.86        | 5.69 | 1.09 | 9.6   | 9.48        | 5.34  | 1.16 | 11.0  |
| 9              | 3  | 9.73                | 6.41 | 2.79 | 63.1  | 8.56        | 7.24 | 2.45 | 48.8 | 9.45        | 6.72 | 2.71 | 59.6  | 10.26       | 6.31 | 2.94 | 70.2  | 10.92       | 5.97  | 3.13 | 79.6  |
|                | 4  | 9.18                | 6.18 | 1.97 | 31.6  | 8.05        | 7.03 | 1.73 | 24.3 | 8.9         | 6.52 | 1.91 | 29.7  | 9.67        | 6.13 | 2.08 | 35.1  | 10.36       | 5.76  | 2.23 | 40.3  |
|                | 5  | 8.69                | 5.92 | 1.49 | 18.1  | 7.45        | 6.87 | 1.28 | 13.3 | 8.41        | 6.31 | 1.45 | 17.0  | 9.16        | 5.87 | 1.58 | 20.2  | 9.86        | 5.5   | 1.7  | 23.3  |
|                | 6  | 8.11                | 5.7  | 1.16 | 11.0  | 6.88        | 6.65 | 0.99 | 7.9  | 7.82        | 6.1  | 1.12 | 10.2  | 8.66        | 5.6  | 1.24 | 12.5  | 9.34        | 5.24  | 1.34 | 14.5  |
|                | 7  | 7.5                 | 5.43 | 0.92 | 6.9   | 6.42        | /    | 0.79 | 5.1  | 7.24        | 5.83 | 0.89 | 6.4   | 8.02        | 5.43 | 0.99 | 7.9   | 8.69        | 5.01  | 1.07 | 9.2   |
| 10             | 3  | 8.92                | 6.08 | 2.56 | 53.0  | 7.68        | 6.97 | 2.2  | 39.3 | 8.56        | 6.48 | 2.45 | 48.8  | 9.42        | 6.05 | 2.7  | 59.2  | 10.16       | 5.66  | 2.91 | 68.8  |
|                | 4  | 8.37                | 5.84 | 1.8  | 26.3  | 7.1         | 6.83 | 1.53 | 18.9 | 8.08        | 6.26 | 1.74 | 24.5  | 8.9         | 5.82 | 1.91 | 29.7  | 9.57        | 5.44  | 2.06 | 34.3  |
|                | 5  | 7.82                | 5.66 | 1.35 | 14.7  | 6.65        | /    | 1.14 | 10.6 | 7.49        | 6.06 | 1.29 | 13.5  | 8.34        | 5.58 | 1.43 | 16.7  | 9.06        | 5.19  | 1.56 | 19.7  |
|                | 6  | 7.29                | 5.41 | 1.04 | 8.9   | 6.31        | /    | 0.9  | 6.6  | 6.96        | 5.83 | 1    | 8.1   | 7.79        | 5.28 | 1.12 | 10.1  | 8.47        | 4.94  | 1.21 | 12.0  |
|                | 7  | 6.65                | 5.18 | 0.82 | 5.4   | 5.93        | /    | 0.73 | 4.3  | 6.33        | 5.61 | 0.78 | 4.9   | 7.14        | 5.12 | 0.88 | 6.3   | 7.92        | 4.69  | 0.97 | 7.7   |
| 11             | 3  | 8.05                | 5.8  | 2.31 | 43.2  | 6.83        | /    | 1.96 | 31.1 | 7.76        | 6.18 | 2.23 | 40.2  | 8.57        | 5.77 | 2.46 | 49.0  | 9.34        | 5.35  | 2.68 | 58.1  |
|                | 4  | 7.55                | 5.6  | 1.62 | 21.4  | 6.49        | /    | 1.4  | 15.8 | 7.24        | 5.95 | 1.56 | 19.7  | 8.07        | 5.5  | 1.73 | 24.4  | 8.82        | 5.14  | 1.9  | 29.2  |
|                | 5  | 6.97                | 5.38 | 1.2  | 11.7  | 6.18        | /    | 1.06 | 9.2  | 6.65        | 5.8  | 1.14 | 10.6  | 7.5         | 5.27 | 1.29 | 13.5  | 8.24        | 4.89  | 1.42 | 16.3  |
|                | 6  | 6.35                | 5.17 | 0.91 | 6.7   | 5.79        | /    | 0.83 | 5.6  | 6.1         | 5.54 | 0.87 | 6.2   | 6.93        | 5.09 | 0.99 | 8.0   | 7.65        | 4.65  | 1.1  | 9.8   |
|                | 7  | 5.66                | 4.98 | 0.69 | 3.9   | 5.45        | /    | 0.67 | 3.6  | 5.45        | /    | 0.67 | 3.6   | 6.28        | 4.83 | 0.77 | 4.8   | 7.04        | 4.37  | 0.87 | 6.1   |
| 12             | 3  | 7.2                 | 5.53 | 2.06 | 34.6  | 6.32        | /    | 1.81 | 26.6 | 6.85        | 5.96 | 1.96 | 31.3  | 7.76        | 5.44 | 2.23 | 40.2  | 8.48        | 5.06  | 2.43 | 48.0  |
|                | 4  | 6.67                | 5.34 | 1.43 | 16.7  | 6.02        | /    | 1.29 | 13.6 | 6.33        | 5.76 | 1.36 | 15.1  | 7.22        | 5.24 | 1.55 | 19.5  | 7.98        | 4.83  | 1.72 | 23.9  |
|                | 5  | 6.09                | 5.15 | 1.05 | 8.9   | 5.76        | /    | 0.99 | 8.0  | 5.77        | 5.57 | 0.99 | 8.0   | 6.65        | 5.05 | 1.14 | 10.6  | 7.4         | 4.62  | 1.27 | 13.2  |
|                | 6  | 5.41                | 4.98 | 0.78 | 4.9   | 5.35        | /    | 0.77 | 4.8  | 5.35        | 5.25 | 0.77 | 4.8   | 6.03        | 4.83 | 0.86 | 6.1   | 6.78        | 4.36  | 0.97 | 7.7   |
|                | 7  | 4.79                | /    | 0.59 | 2.8   | 4.98        | /    | 0.61 | 3.0  | 4.94        | /    | 0.61 | 3.0   | 5.27        | 4.59 | 0.65 | 3.4   | 6.16        | 4.1   | 0.76 | 4.7   |
| 13             | 3  | 6.29                | 5.28 | 1.8  | 26.4  | 5.83        | /    | 1.67 | 22.7 | 5.93        | 5.73 | 1.7  | 23.5  | 6.84        | 5.18 | 1.96 | 31.2  | 7.65        | 4.78  | 2.19 | 39.0  |
|                | 4  | 5.76                | 5.08 | 1.24 | 12.4  | 5.56        | /    | 1.19 | 11.6 | 5.56        | 5.45 | 1.19 | 11.6  | 6.29        | 5.05 | 1.35 | 14.8  | 7.1         | 4.55  | 1.53 | 18.9  |
|                | 5  | 5.14                | 5.02 | 0.88 | 6.3   | 5.18        | /    | 0.89 | 6.4  | 5.19        | /    | 0.89 | 6.5   | 5.74        | 4.81 | 0.99 | 7.9   | 6.54        | 4.33  | 1.12 | 10.3  |
|                | 6  | 4.68                | /    | 0.67 | 3.6   | 4.83        | /    | 0.69 | 3.9  | 4.83        | /    | 0.69 | 3.9   | 5.06        | 4.63 | 0.73 | 4.3   | 5.9         | 4.1   | 0.85 | 5.8   |
|                | 7  | 4.27                | /    | 0.52 | 2.2   | 4.43        | /    | 0.54 | 2.4  | 4.44        | /    | 0.55 | 2.4   | 4.44        | 4.34 | 0.55 | 2.4   | 5.17        | 3.87  | 0.63 | 3.3   |

Cooling capacity

| MDKT3H-1400G70 |    |                     |      |      |       |             |       |      |       |             |      |      |       |             |      |      |       |             |       |      |       |
|----------------|----|---------------------|------|------|-------|-------------|-------|------|-------|-------------|------|------|-------|-------------|------|------|-------|-------------|-------|------|-------|
| EWT            | Δt | Air inlet condition |      |      |       |             |       |      |       |             |      |      |       |             |      |      |       |             |       |      |       |
|                |    | DB:26.7 WB:19.4     |      |      |       | DB:27 WB:18 |       |      |       | DB:27 WB:19 |      |      |       | DB:27 WB:20 |      |      |       | DB:29 WB:21 |       |      |       |
|                |    | TC                  | SC   | WF   | WPD   | TC          | SC    | WF   | WPD   | TC          | SC   | WF   | WPD   | TC          | SC   | WF   | WPD   | TC          | SC    | WF   | WPD   |
| 5              | 3  | 15.29               | 9.21 | 4.38 | 162.4 | 14.03       | 10.13 | 4.02 | 136.6 | 14.98       | 9.61 | 4.29 | 155.8 | 15.84       | 9.19 | 4.54 | 174.3 | 16.73       | 8.78  | 4.8  | 194.3 |
|                | 4  | 14.7                | 8.94 | 3.16 | 84.4  | 13.51       | 9.82  | 2.9  | 71.3  | 14.46       | 9.33 | 3.11 | 81.7  | 15.31       | 8.94 | 3.29 | 91.5  | 16.07       | 8.48  | 3.45 | 100.9 |
|                | 5  | 14.06               | 8.62 | 2.42 | 49.4  | 12.87       | 9.59  | 2.21 | 41.4  | 13.78       | 9.04 | 2.37 | 47.5  | 14.7        | 8.61 | 2.53 | 54.0  | 15.45       | 13.35 | 2.66 | 59.6  |
|                | 6  | 13.44               | 8.38 | 1.93 | 31.4  | 12.24       | 9.26  | 1.75 | 26.0  | 13.18       | 8.73 | 1.89 | 30.2  | 14.1        | 8.28 | 2.02 | 34.5  | 14.77       | 7.86  | 2.12 | 37.9  |
|                | 7  | 12.78               | 7.98 | 1.57 | 20.8  | 11.57       | 9.04  | 1.42 | 17.1  | 12.48       | 8.43 | 1.53 | 19.9  | 13.4        | 7.98 | 1.65 | 22.9  | 14.15       | 7.55  | 1.74 | 25.5  |
| 6              | 3  | 14.42               | 8.85 | 4.13 | 144.5 | 13.14       | 9.75  | 3.77 | 120.0 | 14.1        | 9.23 | 4.04 | 138.0 | 15.01       | 8.8  | 4.3  | 156.5 | 15.88       | 8.38  | 4.55 | 175.1 |
|                | 4  | 13.85               | 8.54 | 2.98 | 75.0  | 12.55       | 9.44  | 2.7  | 61.6  | 13.52       | 8.92 | 2.91 | 71.4  | 14.42       | 8.52 | 3.1  | 81.3  | 15.24       | 8.1   | 3.28 | 90.7  |
|                | 5  | 13.18               | 8.23 | 2.27 | 43.4  | 11.98       | 9.18  | 2.06 | 35.9  | 12.92       | 8.66 | 2.22 | 41.7  | 13.77       | 8.16 | 2.37 | 47.4  | 14.63       | 7.79  | 2.52 | 53.5  |
|                | 6  | 12.55               | 7.98 | 1.8  | 27.4  | 11.36       | 8.87  | 1.63 | 22.4  | 12.26       | 8.33 | 1.76 | 26.1  | 13.18       | 7.84 | 1.89 | 30.2  | 13.9        | 7.45  | 1.99 | 33.6  |
|                | 7  | 11.9                | 7.62 | 1.46 | 18.1  | 10.65       | 8.64  | 1.31 | 14.5  | 11.6        | 8.1  | 1.43 | 17.2  | 12.43       | 7.58 | 1.53 | 19.7  | 13.28       | 7.13  | 1.63 | 22.5  |
| 7              | 3  | 13.47               | 8.42 | 3.86 | 126.0 | 12.23       | 9.37  | 3.5  | 103.8 | 13.18       | 8.85 | 3.78 | 120.6 | 14.15       | 8.4  | 4.06 | 139.0 | 14.94       | 7.97  | 4.28 | 155.1 |
|                | 4  | 12.92               | 8.12 | 2.78 | 65.2  | 11.58       | 9.16  | 2.49 | 52.4  | 12.57       | 8.55 | 2.7  | 61.7  | 13.51       | 8.12 | 2.9  | 71.3  | 14.35       | 7.71  | 3.09 | 80.5  |
|                | 5  | 12.26               | 7.83 | 2.11 | 37.6  | 11          | 8.87  | 1.89 | 30.2  | 12          | 8.26 | 2.06 | 36.0  | 12.87       | 7.76 | 2.21 | 41.4  | 13.66       | 7.39  | 2.35 | 46.7  |
|                | 6  | 11.62               | 7.6  | 1.67 | 23.4  | 10.35       | 8.59  | 1.48 | 18.6  | 11.41       | 7.97 | 1.64 | 22.6  | 12.28       | 7.46 | 1.76 | 26.2  | 13.04       | 7.06  | 1.87 | 29.5  |
|                | 7  | 11                  | 7.26 | 1.35 | 15.4  | 9.66        | 8.28  | 1.19 | 11.9  | 10.63       | 7.72 | 1.31 | 14.4  | 11.55       | 7.22 | 1.42 | 17.0  | 12.35       | 6.77  | 1.52 | 19.4  |
| 8              | 3  | 12.55               | 8.05 | 3.6  | 109.5 | 11.2        | 9.04  | 3.21 | 87.2  | 12.26       | 8.43 | 3.51 | 104.4 | 13.19       | 7.97 | 3.78 | 120.9 | 14.04       | 7.53  | 4.03 | 137.0 |
|                | 4  | 12                  | 7.77 | 2.58 | 56.3  | 10.65       | 8.74  | 2.29 | 44.3  | 11.64       | 8.24 | 2.5  | 52.9  | 12.55       | 7.71 | 2.7  | 61.6  | 13.37       | 7.31  | 2.87 | 69.8  |
|                | 5  | 11.39               | 7.45 | 1.96 | 32.5  | 9.99        | 8.48  | 1.72 | 25.0  | 11.05       | 7.9  | 1.9  | 30.5  | 11.98       | 7.43 | 2.06 | 35.9  | 12.8        | 7.01  | 2.2  | 40.9  |
|                | 6  | 10.65               | 7.22 | 1.53 | 19.7  | 9.35        | 8.26  | 1.34 | 15.2  | 10.44       | 7.62 | 1.5  | 18.9  | 11.36       | 7.1  | 1.63 | 22.4  | 12.16       | 6.68  | 1.74 | 25.7  |
|                | 7  | 10.03               | 6.89 | 1.23 | 12.8  | 8.68        | 7.91  | 1.07 | 9.6   | 9.71        | 7.36 | 1.19 | 12.0  | 10.63       | 6.82 | 1.31 | 14.4  | 11.38       | 6.41  | 1.4  | 16.5  |
| 9              | 3  | 11.67               | 7.69 | 3.35 | 94.6  | 10.27       | 8.69  | 2.94 | 73.2  | 11.34       | 8.07 | 3.25 | 89.3  | 12.31       | 7.57 | 3.53 | 105.3 | 13.11       | 7.17  | 3.76 | 119.3 |
|                | 4  | 11.01               | 7.41 | 2.37 | 47.4  | 9.66        | 8.43  | 2.08 | 36.5  | 10.68       | 7.83 | 2.3  | 44.6  | 11.6        | 7.36 | 2.49 | 52.6  | 12.43       | 6.91  | 2.67 | 60.4  |
|                | 5  | 10.42               | 7.1  | 1.79 | 27.2  | 8.94        | 8.24  | 1.54 | 20.0  | 10.1        | 7.57 | 1.74 | 25.5  | 11          | 7.05 | 1.89 | 30.2  | 11.83       | 6.6   | 2.03 | 35.0  |
|                | 6  | 9.73                | 6.84 | 1.39 | 16.4  | 8.26        | 7.98  | 1.18 | 11.8  | 9.39        | 7.32 | 1.35 | 15.3  | 10.39       | 6.72 | 1.49 | 18.7  | 11.2        | 6.29  | 1.61 | 21.8  |
|                | 7  | 9                   | 6.51 | 1.11 | 10.3  | 7.71        | /     | 0.95 | 7.6   | 8.69        | 7    | 1.07 | 9.6   | 9.63        | 6.51 | 1.18 | 11.8  | 10.42       | 6.01  | 1.28 | 13.9  |
| 10             | 3  | 10.7                | 7.29 | 3.07 | 79.5  | 9.21        | 8.36  | 2.64 | 58.9  | 10.27       | 7.77 | 2.94 | 73.2  | 11.31       | 7.26 | 3.24 | 88.8  | 12.19       | 6.79  | 3.49 | 103.2 |
|                | 4  | 10.04               | 7.01 | 2.16 | 39.4  | 8.52        | 8.19  | 1.83 | 28.4  | 9.7         | 7.52 | 2.08 | 36.7  | 10.68       | 6.98 | 2.3  | 44.6  | 11.48       | 6.53  | 2.47 | 51.5  |
|                | 5  | 9.39                | 6.79 | 1.61 | 22.0  | 7.98        | /     | 1.37 | 15.9  | 8.99        | 7.27 | 1.55 | 20.2  | 10.01       | 6.7  | 1.72 | 25.0  | 10.87       | 6.23  | 1.87 | 29.6  |
|                | 6  | 8.74                | 6.49 | 1.25 | 13.3  | 7.57        | /     | 1.08 | 9.9   | 8.35        | 7    | 1.2  | 12.1  | 9.35        | 6.34 | 1.34 | 15.2  | 10.16       | 5.92  | 1.46 | 17.9  |
|                | 7  | 7.98                | 6.22 | 0.98 | 8.1   | 7.12        | /     | 0.87 | 6.5   | 7.6         | 6.74 | 0.93 | 7.4   | 8.57        | 6.15 | 1.05 | 9.4   | 9.51        | 5.63  | 1.17 | 11.5  |
| 11             | 3  | 9.66                | 6.96 | 2.77 | 64.8  | 8.19        | /     | 2.35 | 46.6  | 9.32        | 7.41 | 2.67 | 60.3  | 10.29       | 6.93 | 2.95 | 73.5  | 11.2        | 6.42  | 3.21 | 87.2  |
|                | 4  | 9.06                | 6.72 | 1.95 | 32.0  | 7.79        | /     | 1.68 | 23.7  | 8.69        | 7.13 | 1.87 | 29.5  | 9.68        | 6.6  | 2.08 | 36.6  | 10.58       | 6.16  | 2.27 | 43.7  |
|                | 5  | 8.36                | 6.46 | 1.44 | 17.5  | 7.41        | /     | 1.27 | 13.7  | 7.98        | 6.96 | 1.37 | 15.9  | 9           | 6.32 | 1.55 | 20.3  | 9.89        | 5.87  | 1.7  | 24.4  |
|                | 6  | 7.62                | 6.2  | 1.09 | 10.1  | 6.94        | /     | 1    | 8.4   | 7.32        | 6.65 | 1.05 | 9.3   | 8.31        | 6.11 | 1.19 | 12.0  | 9.18        | 5.58  | 1.32 | 14.6  |
|                | 7  | 6.79                | 5.97 | 0.83 | 5.9   | 6.55        | /     | 0.8  | 5.5   | 6.55        | /    | 0.8  | 5.5   | 7.53        | 5.8  | 0.93 | 7.2   | 8.45        | 5.25  | 1.04 | 9.1   |
| 12             | 3  | 8.64                | 6.63 | 2.48 | 51.9  | 7.58        | /     | 2.17 | 40.0  | 8.23        | 7.15 | 2.36 | 47.0  | 9.32        | 6.53 | 2.67 | 60.3  | 10.18       | 6.08  | 2.92 | 72.0  |
|                | 4  | 8                   | 6.41 | 1.72 | 25.0  | 7.22        | /     | 1.55 | 20.4  | 7.6         | 6.91 | 1.63 | 22.6  | 8.66        | 6.29 | 1.86 | 29.3  | 9.58        | 5.8   | 2.06 | 35.8  |
|                | 5  | 7.31                | 6.18 | 1.26 | 13.4  | 6.91        | /     | 1.19 | 11.9  | 6.93        | 6.68 | 1.19 | 12.0  | 7.98        | 6.06 | 1.37 | 15.9  | 8.88        | 5.54  | 1.53 | 19.7  |
|                | 6  | 6.49                | 5.97 | 0.93 | 7.3   | 6.42        | /     | 0.92 | 7.2   | 6.42        | 6.3  | 0.92 | 7.2   | 7.24        | 5.8  | 1.04 | 9.1   | 8.14        | 5.23  | 1.17 | 11.5  |
|                | 7  | 5.75                | /    | 0.71 | 4.2   | 5.97        | /     | 0.73 | 4.6   | 5.92        | /    | 0.73 | 4.5   | 6.32        | 5.51 | 0.78 | 5.1   | 7.39        | 4.92  | 0.91 | 7.0   |
| 13             | 3  | 7.55                | 6.34 | 2.16 | 39.6  | 7           | /     | 2.01 | 34.0  | 7.12        | 6.87 | 2.04 | 35.2  | 8.21        | 6.22 | 2.35 | 46.8  | 9.18        | 5.73  | 2.63 | 58.5  |
|                | 4  | 6.91                | 6.1  | 1.49 | 18.7  | 6.67        | /     | 1.43 | 17.4  | 6.67        | 6.55 | 1.43 | 17.4  | 7.55        | 6.06 | 1.62 | 22.3  | 8.52        | 5.45  | 1.83 | 28.4  |
|                | 5  | 6.16                | 6.03 | 1.06 | 9.5   | 6.22        | /     | 1.07 | 9.7   | 6.23        | /    | 1.07 | 9.7   | 6.89        | 5.77 | 1.19 | 11.9  | 7.84        | 5.19  | 1.35 | 15.4  |
|                | 6  | 5.61                | /    | 0.8  | 5.5   | 5.8         | /     | 0.83 | 5.8   | 5.8         | /    | 0.83 | 5.8   | 6.08        | 5.56 | 0.87 | 6.4   | 7.08        | 4.92  | 1.02 | 8.7   |
|                | 7  | 5.13                | /    | 0.63 | 3.4   | 5.32        | /     | 0.65 | 3.6   | 5.33        | /    | 0.66 | 3.6   | 5.33        | 5.21 | 0.66 | 3.6   | 6.2         | 4.64  | 0.76 | 4.9   |

Cooling capacity

| MDKT3H-1600G100 |    |                     |       |      |       |             |       |      |       |             |       |      |       |             |       |      |       |             |       |      |       |
|-----------------|----|---------------------|-------|------|-------|-------------|-------|------|-------|-------------|-------|------|-------|-------------|-------|------|-------|-------------|-------|------|-------|
| EWT             | Δt | Air inlet condition |       |      |       |             |       |      |       |             |       |      |       |             |       |      |       |             |       |      |       |
|                 |    | DB:26.7 WB:19.4     |       |      |       | DB:27 WB:18 |       |      |       | DB:27 WB:19 |       |      |       | DB:27 WB:20 |       |      |       | DB:29 WB:21 |       |      |       |
|                 |    | TC                  | SC    | WF   | WPD   | TC          | SC    | WF   | WPD   | TC          | SC    | WF   | WPD   | TC          | SC    | WF   | WPD   | TC          | SC    | WF   | WPD   |
| 5               | 3  | 17.97               | 10.82 | 5.15 | 234.5 | 16.48       | 11.9  | 4.72 | 197.3 | 17.6        | 11.29 | 5.05 | 225.0 | 18.62       | 10.8  | 5.34 | 251.8 | 19.65       | 10.32 | 5.63 | 280.7 |
|                 | 4  | 17.27               | 10.5  | 3.71 | 122.0 | 15.87       | 11.54 | 3.41 | 102.9 | 16.99       | 10.97 | 3.65 | 118.0 | 17.99       | 10.5  | 3.87 | 132.2 | 18.88       | 9.97  | 4.06 | 145.7 |
|                 | 5  | 16.52               | 10.13 | 2.84 | 71.4  | 15.12       | 11.27 | 2.6  | 59.8  | 16.2        | 10.62 | 2.79 | 68.6  | 17.27       | 10.11 | 2.97 | 78.1  | 18.15       | 15.69 | 3.12 | 86.2  |
|                 | 6  | 15.79               | 9.85  | 2.26 | 45.3  | 14.38       | 10.89 | 2.06 | 37.6  | 15.48       | 10.25 | 2.22 | 43.6  | 16.56       | 9.73  | 2.37 | 49.8  | 17.36       | 9.24  | 2.49 | 54.7  |
|                 | 7  | 15.02               | 9.38  | 1.84 | 30.1  | 13.59       | 10.62 | 1.67 | 24.7  | 14.67       | 9.91  | 1.8  | 28.7  | 15.75       | 9.38  | 1.93 | 33.1  | 16.62       | 8.87  | 2.04 | 36.9  |
| 6               | 3  | 16.95               | 10.4  | 4.86 | 208.7 | 15.44       | 11.45 | 4.43 | 173.3 | 16.56       | 10.84 | 4.75 | 199.3 | 17.64       | 10.34 | 5.06 | 226.1 | 18.66       | 9.85  | 5.35 | 252.9 |
|                 | 4  | 16.28               | 10.03 | 3.5  | 108.3 | 14.75       | 11.09 | 3.17 | 88.9  | 15.89       | 10.48 | 3.42 | 103.2 | 16.95       | 10.01 | 3.64 | 117.4 | 17.9        | 9.52  | 3.85 | 131.0 |
|                 | 5  | 15.48               | 9.66  | 2.66 | 62.7  | 14.08       | 10.78 | 2.42 | 51.9  | 15.18       | 10.17 | 2.61 | 60.3  | 16.18       | 9.58  | 2.78 | 68.4  | 17.19       | 9.16  | 2.96 | 77.3  |
|                 | 6  | 14.75               | 9.38  | 2.11 | 39.5  | 13.35       | 10.42 | 1.91 | 32.4  | 14.41       | 9.79  | 2.06 | 37.7  | 15.48       | 9.22  | 2.22 | 43.6  | 16.34       | 8.75  | 2.34 | 48.5  |
|                 | 7  | 13.98               | 8.95  | 1.72 | 26.1  | 12.51       | 10.15 | 1.54 | 20.9  | 13.63       | 9.52  | 1.67 | 24.8  | 14.61       | 8.91  | 1.79 | 28.5  | 15.61       | 8.38  | 1.92 | 32.5  |
| 7               | 3  | 15.83               | 9.89  | 4.54 | 182.1 | 14.36       | 11.01 | 4.12 | 149.9 | 15.48       | 10.4  | 4.44 | 174.2 | 16.62       | 9.87  | 4.77 | 200.8 | 17.56       | 9.36  | 5.03 | 224.0 |
|                 | 4  | 15.18               | 9.54  | 3.26 | 94.2  | 13.61       | 10.76 | 2.93 | 75.7  | 14.77       | 10.05 | 3.18 | 89.2  | 15.87       | 9.54  | 3.41 | 102.9 | 16.87       | 9.05  | 3.63 | 116.3 |
|                 | 5  | 14.41               | 9.2   | 2.48 | 54.3  | 12.92       | 10.42 | 2.22 | 43.7  | 14.1        | 9.71  | 2.43 | 60.0  | 15.12       | 9.12  | 2.6  | 59.8  | 16.05       | 8.69  | 2.76 | 67.4  |
|                 | 6  | 13.65               | 8.93  | 1.96 | 33.9  | 12.17       | 10.09 | 1.74 | 26.9  | 13.41       | 9.36  | 1.92 | 32.7  | 14.43       | 8.77  | 2.07 | 37.8  | 15.32       | 8.3   | 2.2  | 42.6  |
|                 | 7  | 12.92               | 8.53  | 1.59 | 22.3  | 11.35       | 9.73  | 1.39 | 17.2  | 12.49       | 9.07  | 1.53 | 20.8  | 13.57       | 8.48  | 1.67 | 24.6  | 14.51       | 7.96  | 1.78 | 28.1  |
| 8               | 3  | 14.75               | 9.46  | 4.23 | 158.1 | 13.16       | 10.62 | 3.77 | 125.9 | 14.41       | 9.91  | 4.13 | 150.8 | 15.5        | 9.36  | 4.44 | 174.6 | 16.5        | 8.85  | 4.73 | 197.8 |
|                 | 4  | 14.1                | 9.14  | 3.03 | 81.3  | 12.51       | 10.27 | 2.69 | 64.0  | 13.67       | 9.68  | 2.94 | 76.4  | 14.75       | 9.05  | 3.17 | 88.9  | 15.71       | 8.59  | 3.38 | 100.8 |
|                 | 5  | 13.39               | 8.75  | 2.3  | 46.9  | 11.74       | 9.97  | 2.02 | 36.1  | 12.98       | 9.28  | 2.23 | 44.1  | 14.08       | 8.73  | 2.42 | 51.9  | 15.04       | 8.24  | 2.59 | 59.1  |
|                 | 6  | 12.51               | 8.48  | 1.79 | 28.4  | 10.99       | 9.71  | 1.57 | 21.9  | 12.27       | 8.95  | 1.76 | 27.3  | 13.35       | 8.34  | 1.91 | 32.4  | 14.28       | 7.85  | 2.05 | 37.1  |
|                 | 7  | 11.78               | 8.1   | 1.45 | 18.5  | 10.19       | 9.3   | 1.25 | 13.9  | 11.41       | 8.65  | 1.4  | 17.4  | 12.49       | 8.02  | 1.53 | 20.8  | 13.37       | 7.53  | 1.64 | 23.9  |
| 9               | 3  | 13.71               | 9.03  | 3.93 | 136.6 | 12.07       | 10.21 | 3.46 | 105.8 | 13.33       | 9.48  | 3.82 | 129.0 | 14.47       | 8.89  | 4.15 | 152.1 | 15.4        | 8.42  | 4.42 | 172.4 |
|                 | 4  | 12.94               | 8.71  | 2.78 | 68.4  | 11.35       | 9.91  | 2.44 | 52.7  | 12.55       | 9.2   | 2.7  | 64.4  | 13.63       | 8.65  | 2.93 | 76.0  | 14.61       | 8.12  | 3.14 | 87.2  |
|                 | 5  | 12.25               | 8.34  | 2.11 | 39.2  | 10.5        | 9.68  | 1.81 | 28.8  | 11.86       | 8.89  | 2.04 | 36.8  | 12.92       | 8.28  | 2.22 | 43.7  | 13.9        | 7.75  | 2.39 | 50.5  |
|                 | 6  | 11.43               | 8.04  | 1.64 | 23.8  | 9.71        | 9.38  | 1.39 | 17.1  | 11.03       | 8.61  | 1.58 | 22.1  | 12.21       | 7.89  | 1.75 | 27.1  | 13.16       | 7.39  | 1.89 | 31.5  |
|                 | 7  | 10.58               | 7.65  | 1.3  | 14.9  | 9.05        | /     | 1.11 | 10.9  | 10.21       | 8.22  | 1.25 | 13.9  | 11.31       | 7.65  | 1.39 | 17.1  | 12.25       | 7.06  | 1.5  | 20.0  |
| 10              | 3  | 12.57               | 8.57  | 3.6  | 114.9 | 10.82       | 9.83  | 3.1  | 85.1  | 12.07       | 9.14  | 3.46 | 105.8 | 13.29       | 8.53  | 3.81 | 128.3 | 14.32       | 7.98  | 4.11 | 149.1 |
|                 | 4  | 11.8                | 8.24  | 2.54 | 56.9  | 10.01       | 9.62  | 2.15 | 41.0  | 11.39       | 8.83  | 2.45 | 53.1  | 12.55       | 8.2   | 2.7  | 64.4  | 13.49       | 7.67  | 2.9  | 74.4  |
|                 | 5  | 11.03               | 7.98  | 1.9  | 31.8  | 9.38        | /     | 1.61 | 23.0  | 10.56       | 8.55  | 1.82 | 29.2  | 11.76       | 7.87  | 2.02 | 36.2  | 12.78       | 7.32  | 2.2  | 42.7  |
|                 | 6  | 10.27               | 7.63  | 1.47 | 19.2  | 8.89        | /     | 1.27 | 14.4  | 9.81        | 8.22  | 1.41 | 17.5  | 10.99       | 7.45  | 1.57 | 21.9  | 11.94       | 6.96  | 1.71 | 25.9  |
|                 | 7  | 9.38                | 7.3   | 1.15 | 11.7  | 8.36        | /     | 1.03 | 9.3   | 8.93        | 7.91  | 1.1  | 10.7  | 10.07       | 7.22  | 1.24 | 13.5  | 11.17       | 6.61  | 1.37 | 16.7  |
| 11              | 3  | 11.35               | 8.18  | 3.25 | 93.7  | 9.62        | /     | 2.76 | 67.3  | 10.95       | 8.71  | 3.14 | 87.1  | 12.09       | 8.14  | 3.46 | 106.1 | 13.16       | 7.55  | 3.77 | 125.9 |
|                 | 4  | 10.64               | 7.89  | 2.29 | 46.3  | 9.16        | /     | 1.97 | 34.3  | 10.21       | 8.38  | 2.2  | 42.6  | 11.37       | 7.75  | 2.45 | 52.9  | 12.43       | 7.24  | 2.67 | 63.2  |
|                 | 5  | 9.83                | 7.59  | 1.69 | 25.3  | 8.71        | /     | 1.5  | 19.8  | 9.38        | 8.18  | 1.61 | 23.0  | 10.58       | 7.43  | 1.82 | 29.3  | 11.62       | 6.9   | 2    | 35.3  |
|                 | 6  | 8.95                | 7.28  | 1.28 | 14.6  | 8.16        | /     | 1.17 | 12.1  | 8.61        | 7.81  | 1.23 | 13.5  | 9.77        | 7.18  | 1.4  | 17.3  | 10.78       | 6.55  | 1.55 | 21.1  |
|                 | 7  | 7.98                | 7.02  | 0.98 | 8.5   | 7.69        | /     | 0.94 | 7.9   | 7.69        | /     | 0.94 | 7.9   | 8.85        | 6.82  | 1.09 | 10.5  | 9.93        | 6.16  | 1.22 | 13.2  |
| 12              | 3  | 10.15               | 7.79  | 2.91 | 74.9  | 8.91        | /     | 2.55 | 57.7  | 9.66        | 8.4   | 2.77 | 67.9  | 10.95       | 7.67  | 3.14 | 87.1  | 11.96       | 7.14  | 3.43 | 104.0 |
|                 | 4  | 9.4                 | 7.53  | 2.02 | 36.1  | 8.48        | /     | 1.82 | 29.4  | 8.93        | 8.12  | 1.92 | 32.6  | 10.17       | 7.39  | 2.19 | 42.3  | 11.25       | 6.82  | 2.42 | 51.7  |
|                 | 5  | 8.59                | 7.26  | 1.48 | 19.3  | 8.12        | /     | 1.4  | 17.2  | 8.14        | 7.85  | 1.4  | 17.3  | 9.38        | 7.12  | 1.61 | 23.0  | 10.44       | 6.51  | 1.8  | 28.5  |
|                 | 6  | 7.63                | 7.02  | 1.09 | 10.6  | 7.55        | /     | 1.08 | 10.4  | 7.55        | 7.41  | 1.08 | 10.4  | 8.5         | 6.82  | 1.22 | 13.1  | 9.56        | 6.14  | 1.37 | 16.6  |
|                 | 7  | 6.75                | /     | 0.83 | 6.1   | 7.02        | /     | 0.86 | 6.6   | 6.96        | /     | 0.85 | 6.5   | 7.43        | 6.47  | 0.91 | 7.4   | 8.69        | 5.78  | 1.07 | 10.1  |
| 13              | 3  | 8.87                | 7.45  | 2.54 | 57.2  | 8.22        | /     | 2.36 | 49.1  | 8.36        | 8.08  | 2.4  | 50.8  | 9.64        | 7.3   | 2.76 | 67.6  | 10.78       | 6.73  | 3.09 | 84.5  |
|                 | 4  | 8.12                | 7.16  | 1.75 | 26.9  | 7.83        | /     | 1.68 | 25.1  | 7.83        | 7.69  | 1.68 | 25.1  | 8.87        | 7.12  | 1.91 | 32.2  | 10.01       | 6.41  | 2.15 | 41.0  |
|                 | 5  | 7.24                | 7.08  | 1.25 | 13.7  | 7.3         | /     | 1.26 | 14.0  | 7.32        | /     | 1.26 | 14.0  | 8.1         | 6.78  | 1.39 | 17.2  | 9.22        | 6.1   | 1.59 | 22.2  |
|                 | 6  | 6.59                | /     | 0.94 | 7.9   | 6.82        | /     | 0.98 | 8.4   | 6.82        | /     | 0.98 | 8.4   | 7.14        | 6.53  | 1.02 | 9.3   | 8.32        | 5.78  | 1.19 | 12.6  |
|                 | 7  | 6.02                | /     | 0.74 | 4.8   | 6.25        | /     | 0.77 | 5.2   | 6.27        | /     | 0.77 | 5.2   | 6.27        | 6.12  | 0.77 | 5.2   | 7.28        | 5.45  | 0.89 | 7.1   |

Cooling capacity

| MDKT3H-1800G100 |    |                     |       |      |       |             |       |      |       |             |       |      |       |             |       |      |       |             |       |      |       |  |
|-----------------|----|---------------------|-------|------|-------|-------------|-------|------|-------|-------------|-------|------|-------|-------------|-------|------|-------|-------------|-------|------|-------|--|
| EWT             | Δt | Air inlet condition |       |      |       |             |       |      |       |             |       |      |       |             |       |      |       |             |       |      |       |  |
|                 |    | DB:26.7 WB:19.4     |       |      |       | DB:27 WB:18 |       |      |       | DB:27 WB:19 |       |      |       | DB:27 WB:20 |       |      |       | DB:29 WB:21 |       |      |       |  |
|                 |    | TC                  | SC    | WF   | WPD   | TC          | SC    | WF   | WPD   | TC          | SC    | WF   | WPD   | TC          | SC    | WF   | WPD   | TC          | SC    | WF   | WPD   |  |
| 5               | 3  | 20.13               | 12.13 | 5.77 | 405.9 | 18.47       | 13.34 | 5.29 | 341.5 | 19.72       | 12.65 | 5.65 | 389.5 | 20.86       | 12.11 | 5.98 | 435.8 | 22.02       | 11.56 | 6.31 | 485.8 |  |
|                 | 4  | 19.36               | 11.76 | 4.16 | 211.1 | 17.78       | 12.93 | 3.82 | 178.2 | 19.04       | 12.29 | 4.09 | 204.2 | 20.15       | 11.76 | 4.33 | 228.8 | 21.16       | 11.17 | 4.55 | 252.2 |  |
|                 | 5  | 18.51               | 11.35 | 3.18 | 123.6 | 16.94       | 12.63 | 2.91 | 103.5 | 18.15       | 11.9  | 3.12 | 118.7 | 19.36       | 11.33 | 3.33 | 135.1 | 20.34       | 17.58 | 3.5  | 149.1 |  |
|                 | 6  | 17.69               | 11.03 | 2.54 | 78.4  | 16.12       | 12.2  | 2.31 | 65.1  | 17.35       | 11.49 | 2.49 | 75.4  | 18.56       | 10.9  | 2.66 | 86.2  | 19.45       | 10.35 | 2.79 | 94.7  |  |
|                 | 7  | 16.83               | 10.51 | 2.07 | 52.1  | 15.23       | 11.9  | 1.87 | 42.7  | 16.44       | 11.1  | 2.02 | 49.7  | 17.65       | 10.51 | 2.17 | 57.3  | 18.63       | 9.94  | 2.29 | 63.8  |  |
| 6               | 3  | 18.99               | 11.65 | 5.44 | 361.2 | 17.3        | 12.84 | 4.96 | 299.9 | 18.56       | 12.15 | 5.32 | 344.9 | 19.77       | 11.58 | 5.67 | 391.3 | 20.91       | 11.03 | 5.99 | 437.7 |  |
|                 | 4  | 18.24               | 11.24 | 3.92 | 187.4 | 16.53       | 12.43 | 3.55 | 153.9 | 17.81       | 11.74 | 3.83 | 178.6 | 18.99       | 11.22 | 4.08 | 203.2 | 20.06       | 10.67 | 4.31 | 226.8 |  |
|                 | 5  | 17.35               | 10.83 | 2.98 | 108.5 | 15.78       | 12.08 | 2.71 | 89.7  | 17.01       | 11.4  | 2.93 | 104.3 | 18.13       | 10.74 | 3.12 | 118.4 | 19.27       | 10.26 | 3.31 | 133.8 |  |
|                 | 6  | 16.53               | 10.51 | 2.37 | 68.4  | 14.96       | 11.67 | 2.14 | 56.0  | 16.14       | 10.97 | 2.31 | 65.2  | 17.35       | 10.33 | 2.49 | 75.4  | 18.31       | 9.8   | 2.62 | 83.9  |  |
|                 | 7  | 15.66               | 10.03 | 1.92 | 45.1  | 14.02       | 11.38 | 1.72 | 36.2  | 15.28       | 10.67 | 1.88 | 42.9  | 16.37       | 9.99  | 2.01 | 49.3  | 17.49       | 9.39  | 2.15 | 56.3  |  |
| 7               | 3  | 17.74               | 11.08 | 5.08 | 315.1 | 16.1        | 12.33 | 4.61 | 259.5 | 17.35       | 11.65 | 4.97 | 301.5 | 18.63       | 11.06 | 5.34 | 347.5 | 19.68       | 10.49 | 5.64 | 387.7 |  |
|                 | 4  | 17.01               | 10.69 | 3.66 | 163.0 | 15.25       | 12.06 | 3.28 | 131.1 | 16.55       | 11.26 | 3.56 | 154.3 | 17.78       | 10.69 | 3.82 | 178.2 | 18.9        | 10.15 | 4.06 | 201.2 |  |
|                 | 5  | 16.14               | 10.31 | 2.78 | 93.9  | 14.48       | 11.67 | 2.49 | 75.6  | 15.8        | 10.88 | 2.72 | 78.0  | 16.94       | 10.21 | 2.91 | 103.5 | 17.99       | 9.74  | 3.09 | 116.7 |  |
|                 | 6  | 15.3                | 10.01 | 2.19 | 58.6  | 13.63       | 11.31 | 1.95 | 46.5  | 15.02       | 10.49 | 2.15 | 56.5  | 16.16       | 9.83  | 2.32 | 65.4  | 17.17       | 9.3   | 2.46 | 73.8  |  |
|                 | 7  | 14.48               | 9.55  | 1.78 | 38.6  | 12.72       | 10.9  | 1.56 | 29.8  | 14          | 10.17 | 1.72 | 36.1  | 15.21       | 9.51  | 1.87 | 42.5  | 16.26       | 8.91  | 2    | 48.6  |  |
| 8               | 3  | 16.53               | 10.6  | 4.74 | 273.6 | 14.75       | 11.9  | 4.23 | 217.9 | 16.14       | 11.1  | 4.63 | 260.9 | 17.37       | 10.49 | 4.98 | 302.3 | 18.49       | 9.92  | 5.3  | 342.4 |  |
|                 | 4  | 15.8                | 10.24 | 3.4  | 140.6 | 14.02       | 11.51 | 3.01 | 110.8 | 15.32       | 10.85 | 3.29 | 132.2 | 16.53       | 10.15 | 3.55 | 153.9 | 17.6        | 9.62  | 3.78 | 174.5 |  |
|                 | 5  | 15                  | 9.8   | 2.58 | 81.1  | 13.16       | 11.17 | 2.26 | 62.4  | 14.55       | 10.4  | 2.5  | 76.3  | 15.78       | 9.78  | 2.71 | 89.7  | 16.85       | 9.23  | 2.9  | 102.3 |  |
|                 | 6  | 14.02               | 9.51  | 2.01 | 49.2  | 12.31       | 10.88 | 1.76 | 38.0  | 13.75       | 10.03 | 1.97 | 47.3  | 14.96       | 9.35  | 2.14 | 56.0  | 16.01       | 8.8   | 2.29 | 64.1  |  |
|                 | 7  | 13.2                | 9.07  | 1.62 | 32.1  | 11.42       | 10.42 | 1.4  | 24.0  | 12.79       | 9.69  | 1.57 | 30.1  | 14          | 8.98  | 1.72 | 36.1  | 14.98       | 8.44  | 1.84 | 41.3  |  |
| 9               | 3  | 15.37               | 10.12 | 4.41 | 236.5 | 13.52       | 11.45 | 3.88 | 183.1 | 14.93       | 10.62 | 4.28 | 223.3 | 16.21       | 9.96  | 4.65 | 263.2 | 17.26       | 9.44  | 4.95 | 298.3 |  |
|                 | 4  | 14.5                | 9.76  | 3.12 | 118.4 | 12.72       | 11.1  | 2.74 | 91.2  | 14.07       | 10.31 | 3.02 | 111.5 | 15.28       | 9.69  | 3.28 | 131.5 | 16.37       | 9.1   | 3.52 | 151.0 |  |
|                 | 5  | 13.73               | 9.35  | 2.36 | 67.9  | 11.76       | 10.85 | 2.02 | 49.9  | 13.29       | 9.96  | 2.29 | 63.7  | 14.48       | 9.28  | 2.49 | 75.6  | 15.57       | 8.69  | 2.68 | 87.4  |  |
|                 | 6  | 12.81               | 9.01  | 1.84 | 41.1  | 10.88       | 10.51 | 1.56 | 29.6  | 12.36       | 9.64  | 1.77 | 38.2  | 13.68       | 8.85  | 1.96 | 46.9  | 14.75       | 8.28  | 2.11 | 54.5  |  |
|                 | 7  | 11.86               | 8.57  | 1.46 | 25.9  | 10.15       | /     | 1.25 | 18.9  | 11.45       | 9.21  | 1.41 | 24.1  | 12.68       | 8.57  | 1.56 | 29.6  | 13.73       | 7.91  | 1.69 | 34.7  |  |
| 10              | 3  | 14.09               | 9.6   | 4.04 | 198.8 | 12.13       | 11.01 | 3.48 | 147.3 | 13.52       | 10.24 | 3.88 | 183.1 | 14.89       | 9.55  | 4.27 | 222.0 | 16.05       | 8.94  | 4.6  | 258.0 |  |
|                 | 4  | 13.22               | 9.23  | 2.84 | 98.5  | 11.22       | 10.78 | 2.41 | 70.9  | 12.77       | 9.89  | 2.75 | 91.8  | 14.07       | 9.19  | 3.02 | 111.5 | 15.12       | 8.6   | 3.25 | 128.7 |  |
|                 | 5  | 12.36               | 8.94  | 2.13 | 55.1  | 10.51       | /     | 1.81 | 39.8  | 11.83       | 9.58  | 2.04 | 50.5  | 13.18       | 8.82  | 2.27 | 62.6  | 14.32       | 8.21  | 2.46 | 73.9  |  |
|                 | 6  | 11.51               | 8.55  | 1.65 | 33.2  | 9.96        | /     | 1.43 | 24.9  | 10.99       | 9.21  | 1.58 | 30.2  | 12.31       | 8.34  | 1.76 | 38.0  | 13.38       | 7.8   | 1.92 | 44.8  |  |
|                 | 7  | 10.51               | 8.18  | 1.29 | 20.3  | 9.37        | /     | 1.15 | 16.2  | 10.01       | 8.87  | 1.23 | 18.4  | 11.29       | 8.09  | 1.39 | 23.4  | 12.52       | 7.41  | 1.54 | 28.8  |  |
| 11              | 3  | 12.72               | 9.17  | 3.65 | 162.1 | 10.78       | /     | 3.09 | 116.5 | 12.27       | 9.76  | 3.52 | 150.7 | 13.54       | 9.12  | 3.88 | 183.7 | 14.75       | 8.46  | 4.23 | 217.9 |  |
|                 | 4  | 11.92               | 8.85  | 2.56 | 80.1  | 10.26       | /     | 2.21 | 59.3  | 11.45       | 9.39  | 2.46 | 73.8  | 12.74       | 8.69  | 2.74 | 91.5  | 13.93       | 8.12  | 3    | 109.3 |  |
|                 | 5  | 11.01               | 8.5   | 1.89 | 43.7  | 9.76        | /     | 1.68 | 34.3  | 10.51       | 9.17  | 1.81 | 39.8  | 11.86       | 8.32  | 2.04 | 50.7  | 13.02       | 7.73  | 2.24 | 61.1  |  |
|                 | 6  | 10.03               | 8.16  | 1.44 | 25.2  | 9.14        | /     | 1.31 | 20.9  | 9.64        | 8.75  | 1.38 | 23.3  | 10.94       | 8.05  | 1.57 | 30.0  | 12.08       | 7.34  | 1.73 | 36.6  |  |
|                 | 7  | 8.94                | 7.87  | 1.1  | 14.7  | 8.62        | /     | 1.06 | 13.7  | 8.62        | /     | 1.06 | 13.7  | 9.92        | 7.64  | 1.22 | 18.1  | 11.13       | 6.91  | 1.37 | 22.8  |  |
| 12              | 3  | 11.38               | 8.73  | 3.26 | 129.6 | 9.99        | /     | 2.86 | 99.9  | 10.83       | 9.42  | 3.1  | 117.5 | 12.27       | 8.6   | 3.52 | 150.7 | 13.41       | 8     | 3.84 | 180.0 |  |
|                 | 4  | 10.53               | 8.44  | 2.26 | 62.5  | 9.51        | /     | 2.04 | 50.9  | 10.01       | 9.1   | 2.15 | 56.4  | 11.4        | 8.28  | 2.45 | 73.2  | 12.61       | 7.64  | 2.71 | 89.6  |  |
|                 | 5  | 9.62                | 8.14  | 1.65 | 33.4  | 9.1         | /     | 1.56 | 29.8  | 9.12        | 8.8   | 1.57 | 30.0  | 10.51       | 7.98  | 1.81 | 39.8  | 11.7        | 7.3   | 2.01 | 49.3  |  |
|                 | 6  | 8.55                | 7.87  | 1.23 | 18.3  | 8.46        | /     | 1.21 | 17.9  | 8.46        | 8.3   | 1.21 | 17.9  | 9.53        | 7.64  | 1.37 | 22.7  | 10.72       | 6.89  | 1.54 | 28.8  |  |
|                 | 7  | 7.57                | /     | 0.93 | 10.5  | 7.87        | /     | 0.97 | 11.4  | 7.8         | /     | 0.96 | 11.2  | 8.32        | 7.25  | 1.02 | 12.7  | 9.74        | 6.48  | 1.2  | 17.4  |  |
| 13              | 3  | 9.94                | 8.34  | 2.85 | 99.0  | 9.21        | /     | 2.64 | 85.0  | 9.37        | 9.05  | 2.69 | 87.9  | 10.81       | 8.18  | 3.1  | 117.0 | 12.08       | 7.55  | 3.46 | 146.2 |  |
|                 | 4  | 9.1                 | 8.03  | 1.96 | 46.6  | 8.78        | /     | 1.89 | 43.4  | 8.78        | 8.62  | 1.89 | 43.4  | 9.94        | 7.98  | 2.14 | 55.7  | 11.22       | 7.18  | 2.41 | 70.9  |  |
|                 | 5  | 8.12                | 7.93  | 1.4  | 23.8  | 8.18        | /     | 1.41 | 24.2  | 8.21        | /     | 1.41 | 24.3  | 9.07        | 7.59  | 1.56 | 29.7  | 10.33       | 6.84  | 1.78 | 38.5  |  |
|                 | 6  | 7.39                | /     | 1.06 | 13.7  | 7.64        | /     | 1.09 | 14.6  | 7.64        | /     | 1.09 | 14.6  | 8           | 7.32  | 1.15 | 16.0  | 9.32        | 6.48  | 1.34 | 21.8  |  |
|                 | 7  | 6.75                | /     | 0.83 | 8.4   | 7           | /     | 0.86 | 9.0   | 7.02        | /     | 0.86 | 9.1   | 7.02        | 6.86  | 0.86 | 9.1   | 8.16        | 6.11  | 1    | 12.3  |  |

Cooling capacity

| MDKT3H-2200G100 |    |                     |       |      |       |             |       |      |       |             |       |      |       |             |       |      |       |             |       |      |       |
|-----------------|----|---------------------|-------|------|-------|-------------|-------|------|-------|-------------|-------|------|-------|-------------|-------|------|-------|-------------|-------|------|-------|
| EWT             | Δt | Air inlet condition |       |      |       |             |       |      |       |             |       |      |       |             |       |      |       |             |       |      |       |
|                 |    | DB:26.7 WB:19.4     |       |      |       | DB:27 WB:18 |       |      |       | DB:27 WB:19 |       |      |       | DB:27 WB:20 |       |      |       | DB:29 WB:21 |       |      |       |
|                 |    | TC                  | SC    | WF   | WPD   | TC          | SC    | WF   | WPD   | TC          | SC    | WF   | WPD   | TC          | SC    | WF   | WPD   | TC          | SC    | WF   | WPD   |
| 5               | 3  | 25.36               | 15.28 | 7.27 | 586.3 | 23.26       | 16.8  | 6.67 | 493.3 | 24.84       | 15.94 | 7.12 | 562.6 | 26.27       | 15.25 | 7.53 | 629.5 | 27.74       | 14.56 | 7.95 | 701.7 |
|                 | 4  | 24.38               | 14.82 | 5.24 | 304.9 | 22.4        | 16.28 | 4.82 | 257.3 | 23.98       | 15.48 | 5.16 | 294.9 | 25.38       | 14.82 | 5.46 | 330.5 | 26.65       | 14.07 | 5.73 | 364.2 |
|                 | 5  | 23.32               | 14.3  | 4.01 | 178.5 | 21.34       | 15.91 | 3.67 | 149.4 | 22.86       | 14.99 | 3.93 | 171.5 | 24.38       | 14.27 | 4.19 | 195.1 | 25.61       | 22.14 | 4.41 | 215.4 |
|                 | 6  | 22.28               | 13.9  | 3.19 | 113.2 | 20.3        | 15.36 | 2.91 | 94.0  | 21.85       | 14.47 | 3.13 | 108.9 | 23.37       | 13.73 | 3.35 | 124.6 | 24.49       | 13.04 | 3.51 | 136.8 |
|                 | 7  | 21.19               | 13.24 | 2.6  | 75.2  | 19.18       | 14.99 | 2.36 | 61.6  | 20.7        | 13.98 | 2.54 | 71.8  | 22.23       | 13.24 | 2.73 | 82.7  | 23.46       | 12.52 | 2.88 | 92.2  |
| 6               | 3  | 23.92               | 14.67 | 6.86 | 521.8 | 21.8        | 16.17 | 6.25 | 433.2 | 23.37       | 15.31 | 6.7  | 498.2 | 24.9        | 14.59 | 7.14 | 565.2 | 26.33       | 13.9  | 7.55 | 632.3 |
|                 | 4  | 22.97               | 14.16 | 4.94 | 270.7 | 20.82       | 15.65 | 4.48 | 222.3 | 22.43       | 14.79 | 4.82 | 258.0 | 23.92       | 14.13 | 5.14 | 293.5 | 25.27       | 13.44 | 5.43 | 327.5 |
|                 | 5  | 21.85               | 13.64 | 3.76 | 156.8 | 19.87       | 15.22 | 3.42 | 129.6 | 21.42       | 14.36 | 3.68 | 150.6 | 22.83       | 13.53 | 3.93 | 171.1 | 24.26       | 12.92 | 4.17 | 193.3 |
|                 | 6  | 20.82               | 13.24 | 2.98 | 98.8  | 18.84       | 14.7  | 2.7  | 80.9  | 20.33       | 13.81 | 2.91 | 94.2  | 21.85       | 13.01 | 3.13 | 108.9 | 23.06       | 12.35 | 3.31 | 121.2 |
|                 | 7  | 19.73               | 12.63 | 2.42 | 65.2  | 17.66       | 14.33 | 2.17 | 52.2  | 19.24       | 13.44 | 2.36 | 62.0  | 20.62       | 12.58 | 2.53 | 71.2  | 22.02       | 11.83 | 2.71 | 81.3  |
| 7               | 3  | 22.34               | 13.96 | 6.4  | 455.1 | 20.27       | 15.54 | 5.81 | 374.8 | 21.85       | 14.67 | 6.26 | 435.5 | 23.46       | 13.93 | 6.73 | 501.9 | 24.78       | 13.21 | 7.1  | 560.0 |
|                 | 4  | 21.42               | 13.47 | 4.61 | 235.4 | 19.21       | 15.19 | 4.13 | 189.3 | 20.85       | 14.19 | 4.48 | 222.9 | 22.4        | 13.47 | 4.82 | 257.3 | 23.81       | 12.78 | 5.12 | 290.7 |
|                 | 5  | 20.33               | 12.98 | 3.5  | 135.7 | 18.23       | 14.7  | 3.14 | 109.2 | 19.9        | 13.7  | 3.42 | 110.0 | 21.34       | 12.86 | 3.67 | 149.4 | 22.66       | 12.26 | 3.9  | 168.5 |
|                 | 6  | 19.27               | 12.61 | 2.76 | 84.6  | 17.17       | 14.24 | 2.46 | 67.2  | 18.92       | 13.21 | 2.71 | 81.6  | 20.36       | 12.38 | 2.92 | 94.5  | 21.62       | 11.72 | 3.1  | 106.6 |
|                 | 7  | 18.23               | 12.03 | 2.24 | 55.7  | 16.02       | 13.73 | 1.97 | 43.0  | 17.63       | 12.81 | 2.17 | 52.1  | 19.15       | 11.97 | 2.35 | 61.4  | 20.47       | 11.23 | 2.52 | 70.2  |
| 8               | 3  | 20.82               | 13.35 | 5.97 | 395.2 | 18.58       | 14.99 | 5.33 | 314.8 | 20.33       | 13.98 | 5.83 | 376.9 | 21.88       | 13.21 | 6.27 | 436.6 | 23.29       | 12.49 | 6.68 | 494.6 |
|                 | 4  | 19.9                | 12.89 | 4.28 | 203.1 | 17.66       | 14.5  | 3.8  | 160.0 | 19.3        | 13.67 | 4.15 | 191.0 | 20.82       | 12.78 | 4.48 | 222.3 | 22.17       | 12.12 | 4.77 | 252.1 |
|                 | 5  | 18.89               | 12.35 | 3.25 | 117.2 | 16.57       | 14.07 | 2.85 | 90.1  | 18.32       | 13.09 | 3.15 | 110.2 | 19.87       | 12.32 | 3.42 | 129.6 | 21.22       | 11.63 | 3.65 | 147.8 |
|                 | 6  | 17.66               | 11.97 | 2.53 | 71.1  | 15.51       | 13.7  | 2.22 | 54.8  | 17.32       | 12.63 | 2.48 | 68.4  | 18.84       | 11.77 | 2.7  | 80.9  | 20.16       | 11.08 | 2.89 | 92.6  |
|                 | 7  | 16.63               | 11.43 | 2.04 | 46.3  | 14.39       | 13.12 | 1.77 | 34.7  | 16.11       | 12.2  | 1.98 | 43.5  | 17.63       | 11.31 | 2.17 | 52.1  | 18.87       | 10.62 | 2.32 | 59.6  |
| 9               | 3  | 19.35               | 12.75 | 5.55 | 341.6 | 17.03       | 14.42 | 4.88 | 264.4 | 18.81       | 13.38 | 5.39 | 322.6 | 20.42       | 12.55 | 5.85 | 380.1 | 21.74       | 11.89 | 6.23 | 430.9 |
|                 | 4  | 18.26               | 12.29 | 3.93 | 171.1 | 16.02       | 13.98 | 3.45 | 131.7 | 17.72       | 12.98 | 3.81 | 161.0 | 19.24       | 12.2  | 4.14 | 189.9 | 20.62       | 11.46 | 4.43 | 218.0 |
|                 | 5  | 17.29               | 11.77 | 2.97 | 98.1  | 14.82       | 13.67 | 2.55 | 72.1  | 16.74       | 12.55 | 2.88 | 92.0  | 18.23       | 11.69 | 3.14 | 109.2 | 19.61       | 10.94 | 3.37 | 126.3 |
|                 | 6  | 16.14               | 11.34 | 2.31 | 59.4  | 13.7        | 13.24 | 1.96 | 42.8  | 15.56       | 12.15 | 2.23 | 55.2  | 17.23       | 11.14 | 2.47 | 67.7  | 18.58       | 10.42 | 2.66 | 78.7  |
|                 | 7  | 14.93               | 10.8  | 1.83 | 37.3  | 12.78       | /     | 1.57 | 27.4  | 14.42       | 11.6  | 1.77 | 34.8  | 15.97       | 10.8  | 1.96 | 42.7  | 17.29       | 9.96  | 2.12 | 50.1  |
| 10              | 3  | 17.75               | 12.09 | 5.09 | 287.2 | 15.28       | 13.87 | 4.38 | 212.8 | 17.03       | 12.89 | 4.88 | 264.4 | 18.75       | 12.03 | 5.38 | 320.6 | 20.22       | 11.26 | 5.8  | 372.7 |
|                 | 4  | 16.66               | 11.63 | 3.58 | 142.3 | 14.13       | 13.58 | 3.04 | 102.4 | 16.08       | 12.46 | 3.46 | 132.6 | 17.72       | 11.57 | 3.81 | 161.0 | 19.04       | 10.83 | 4.09 | 185.9 |
|                 | 5  | 15.56               | 11.26 | 2.68 | 79.5  | 13.24       | /     | 2.28 | 57.5  | 14.9        | 12.06 | 2.56 | 72.9  | 16.6        | 11.11 | 2.85 | 90.4  | 18.03       | 10.34 | 3.1  | 106.8 |
|                 | 6  | 14.5                | 10.77 | 2.08 | 47.9  | 12.55       | /     | 1.8  | 35.9  | 13.84       | 11.6  | 1.98 | 43.7  | 15.51       | 10.51 | 2.22 | 54.8  | 16.86       | 9.82  | 2.42 | 64.8  |
|                 | 7  | 13.24               | 10.31 | 1.63 | 29.4  | 11.8        | /     | 1.45 | 23.3  | 12.61       | 11.17 | 1.55 | 26.6  | 14.21       | 10.19 | 1.75 | 33.8  | 15.76       | 9.33  | 1.94 | 41.6  |
| 11              | 3  | 16.02               | 11.54 | 4.59 | 234.1 | 13.58       | /     | 3.89 | 168.2 | 15.45       | 12.29 | 4.43 | 217.6 | 17.06       | 11.49 | 4.89 | 265.3 | 18.58       | 10.65 | 5.33 | 314.8 |
|                 | 4  | 15.02               | 11.14 | 3.23 | 115.7 | 12.92       | /     | 2.78 | 85.7  | 14.42       | 11.83 | 3.1  | 106.6 | 16.05       | 10.94 | 3.45 | 132.2 | 17.55       | 10.22 | 3.77 | 157.9 |
|                 | 5  | 13.87               | 10.71 | 2.39 | 63.2  | 12.29       | /     | 2.11 | 49.6  | 13.24       | 11.54 | 2.28 | 57.5  | 14.93       | 10.48 | 2.57 | 73.2  | 16.4        | 9.73  | 2.82 | 88.3  |
|                 | 6  | 12.63               | 10.28 | 1.81 | 36.4  | 11.52       | /     | 1.65 | 30.2  | 12.15       | 11.03 | 1.74 | 33.6  | 13.78       | 10.14 | 1.98 | 43.3  | 15.22       | 9.25  | 2.18 | 52.8  |
|                 | 7  | 11.26               | 9.91  | 1.38 | 21.2  | 10.85       | /     | 1.33 | 19.7  | 10.85       | /     | 1.33 | 19.7  | 12.49       | 9.62  | 1.53 | 26.1  | 14.01       | 8.7   | 1.72 | 32.9  |
| 12              | 3  | 14.33               | 11    | 4.11 | 187.2 | 12.58       | /     | 3.61 | 144.3 | 13.64       | 11.86 | 3.91 | 169.7 | 15.45       | 10.83 | 4.43 | 217.6 | 16.88       | 10.08 | 4.84 | 260.0 |
|                 | 4  | 13.27               | 10.62 | 2.85 | 90.3  | 11.97       | /     | 2.57 | 73.6  | 12.61       | 11.46 | 2.71 | 81.5  | 14.36       | 10.42 | 3.09 | 105.7 | 15.88       | 9.62  | 3.41 | 129.3 |
|                 | 5  | 12.12               | 10.25 | 2.08 | 48.2  | 11.46       | /     | 1.97 | 43.1  | 11.49       | 11.08 | 1.98 | 43.3  | 13.24       | 10.05 | 2.28 | 57.5  | 14.73       | 9.19  | 2.53 | 71.2  |
|                 | 6  | 10.77               | 9.91  | 1.54 | 26.4  | 10.65       | /     | 1.53 | 25.9  | 10.65       | 10.45 | 1.53 | 25.9  | 12          | 9.62  | 1.72 | 32.8  | 13.5        | 8.67  | 1.93 | 41.5  |
|                 | 7  | 9.53                | /     | 1.17 | 15.2  | 9.91        | /     | 1.22 | 16.4  | 9.82        | /     | 1.21 | 16.2  | 10.48       | 9.13  | 1.29 | 18.4  | 12.26       | 8.16  | 1.51 | 25.2  |
| 13              | 3  | 12.52               | 10.51 | 3.59 | 142.9 | 11.6        | /     | 3.33 | 122.7 | 11.8        | 11.4  | 3.38 | 127.0 | 13.61       | 10.31 | 3.9  | 168.9 | 15.22       | 9.5   | 4.36 | 211.2 |
|                 | 4  | 11.46               | 10.11 | 2.46 | 67.3  | 11.06       | /     | 2.38 | 62.7  | 11.06       | 10.85 | 2.38 | 62.7  | 12.52       | 10.05 | 2.69 | 80.4  | 14.13       | 9.05  | 3.04 | 102.4 |
|                 | 5  | 10.22               | 9.99  | 1.76 | 34.3  | 10.31       | /     | 1.77 | 34.9  | 10.34       | /     | 1.78 | 35.1  | 11.43       | 9.56  | 1.97 | 42.9  | 13.01       | 8.61  | 2.24 | 55.6  |
|                 | 6  | 9.3                 | /     | 1.33 | 19.7  | 9.62        | /     | 1.38 | 21.1  | 9.62        | /     | 1.38 | 21.1  | 10.08       | 9.22  | 1.44 | 23.2  | 11.74       | 8.16  | 1.68 | 31.5  |
|                 | 7  | 8.5                 | /     | 1.04 | 12.1  | 8.82        | /     | 1.08 | 13.0  | 8.84        | /     | 1.09 | 13.1  | 8.84        | 8.64  | 1.09 | 13.1  | 10.28       | 7.7   | 1.26 | 17.7  |

Cooling capacity modification coefficient table:

| Speed | 800  |      | 1000 |      | 1200 |      | 1400 |      | 1600 |      | 1800 |      | 2200 |      |
|-------|------|------|------|------|------|------|------|------|------|------|------|------|------|------|
|       | TC   | SC   | TC   | SC   | TC   | SC   | TC   | SC   | TC   | SC   | TC   | SC   | TC   | SC   |
| High  | 1    | 1    | 1    | 1    | 1    | 1    | 1    | 1    | 1    | 1    | 1    | 1    | 1    | 1    |
| Mid   | 0.97 | 0.94 | 0.93 | 0.9  | 0.94 | 0.91 | 0.96 | 0.92 | 0.92 | 0.88 | 0.92 | 0.89 | 0.93 | 0.9  |
| Low   | 0.93 | 0.9  | 0.86 | 0.83 | 0.85 | 0.81 | 0.85 | 0.82 | 0.84 | 0.8  | 0.85 | 0.81 | 0.87 | 0.83 |

**Heating Capacity:**

**Remark:**

**Δt:** Temperature Difference (°C) ; **TH:** Total Heating Capacity (kW);

**WF:** Water Flow (m<sup>3</sup>/h); **WPD:** Water Pressure Drop (kPa)

| <b>MDKT3H-800G70</b>   |                           |      |      |       |      |      |       |      |      |       |      |      |       |      |      |       |      |       |       |      |       |       |      |       |
|------------------------|---------------------------|------|------|-------|------|------|-------|------|------|-------|------|------|-------|------|------|-------|------|-------|-------|------|-------|-------|------|-------|
| Δt                     | Air inlet temp. (20°C DB) |      |      |       |      |      |       |      |      |       |      |      |       |      |      |       |      |       |       |      |       |       |      |       |
|                        | Water inlet temp. (°C)    |      |      |       |      |      |       |      |      |       |      |      |       |      |      |       |      |       |       |      |       |       |      |       |
|                        | 35                        |      |      | 40    |      |      | 45    |      |      | 50    |      |      | 55    |      |      | 60    |      |       | 65    |      |       | 70    |      |       |
|                        | TH                        | WF   | WPD  | TH    | WF   | WPD  | TH    | WF   | WPD  | TH    | WF   | WPD  | TH    | WF   | WPD  | TH    | WF   | WPD   | TH    | WF   | WPD   | TH    | WF   | WPD   |
| 10                     | 3.29                      | 0.28 | 0.4  | 5.16  | 0.44 | 1.0  | 7.14  | 0.61 | 1.9  | 9.01  | 0.77 | 3.0  | 10.89 | 0.94 | 4.4  | 12.81 | 1.10 | 6.1   | 14.65 | 1.26 | 8.0   | 16.50 | 1.42 | 10.1  |
| 8                      | 3.65                      | 0.39 | 0.8  | 5.68  | 0.61 | 1.9  | 7.60  | 0.82 | 3.4  | 9.48  | 1.02 | 5.2  | 11.31 | 1.22 | 7.4  | 13.15 | 1.41 | 10.0  | 15.00 | 1.61 | 13.1  | 16.85 | 1.81 | 16.5  |
| 6                      | 4.22                      | 0.61 | 1.8  | 6.15  | 0.88 | 3.9  | 7.97  | 1.14 | 6.6  | 9.90  | 1.42 | 10.1 | 11.77 | 1.69 | 14.3 | 13.62 | 1.95 | 19.1  | 15.35 | 2.20 | 24.3  | 17.31 | 2.48 | 30.9  |
| <b>MDKT3H-1000G70</b>  |                           |      |      |       |      |      |       |      |      |       |      |      |       |      |      |       |      |       |       |      |       |       |      |       |
| Δt                     | Air inlet temp. (20°C DB) |      |      |       |      |      |       |      |      |       |      |      |       |      |      |       |      |       |       |      |       |       |      |       |
|                        | Water inlet temp. (°C)    |      |      |       |      |      |       |      |      |       |      |      |       |      |      |       |      |       |       |      |       |       |      |       |
|                        | 35                        |      |      | 40    |      |      | 45    |      |      | 50    |      |      | 55    |      |      | 60    |      |       | 65    |      |       | 70    |      |       |
|                        | TH                        | WF   | WPD  | TH    | WF   | WPD  | TH    | WF   | WPD  | TH    | WF   | WPD  | TH    | WF   | WPD  | TH    | WF   | WPD   | TH    | WF   | WPD   | TH    | WF   | WPD   |
| 10                     | 4.52                      | 0.39 | 1.5  | 7.09  | 0.61 | 3.8  | 9.81  | 0.84 | 7.3  | 12.38 | 1.06 | 11.6 | 14.96 | 1.29 | 16.9 | 17.59 | 1.51 | 23.4  | 20.13 | 1.73 | 30.6  | 22.67 | 1.95 | 38.8  |
| 8                      | 5.01                      | 0.54 | 3.0  | 7.80  | 0.84 | 7.2  | 10.45 | 1.12 | 12.9 | 13.03 | 1.40 | 20.0 | 15.53 | 1.67 | 28.5 | 18.07 | 1.94 | 38.5  | 20.61 | 2.22 | 50.1  | 23.14 | 2.49 | 63.2  |
| 6                      | 5.80                      | 0.83 | 7.1  | 8.45  | 1.21 | 15.0 | 10.95 | 1.57 | 25.2 | 13.60 | 1.95 | 38.8 | 16.17 | 2.32 | 54.8 | 18.70 | 2.68 | 73.3  | 21.08 | 3.02 | 93.2  | 23.78 | 3.41 | 118.5 |
| <b>MDKT3H-1200G70</b>  |                           |      |      |       |      |      |       |      |      |       |      |      |       |      |      |       |      |       |       |      |       |       |      |       |
| Δt                     | Air inlet temp. (20°C DB) |      |      |       |      |      |       |      |      |       |      |      |       |      |      |       |      |       |       |      |       |       |      |       |
|                        | Water inlet temp. (°C)    |      |      |       |      |      |       |      |      |       |      |      |       |      |      |       |      |       |       |      |       |       |      |       |
|                        | 35                        |      |      | 40    |      |      | 45    |      |      | 50    |      |      | 55    |      |      | 60    |      |       | 65    |      |       | 70    |      |       |
|                        | TH                        | WF   | WPD  | TH    | WF   | WPD  | TH    | WF   | WPD  | TH    | WF   | WPD  | TH    | WF   | WPD  | TH    | WF   | WPD   | TH    | WF   | WPD   | TH    | WF   | WPD   |
| 10                     | 5.08                      | 0.44 | 1.5  | 7.97  | 0.69 | 3.7  | 11.04 | 0.95 | 7.1  | 13.93 | 1.20 | 11.3 | 16.83 | 1.45 | 16.5 | 19.79 | 1.70 | 22.8  | 22.65 | 1.95 | 29.9  | 25.50 | 2.19 | 37.9  |
| 8                      | 5.63                      | 0.61 | 2.9  | 8.77  | 0.94 | 7.0  | 11.75 | 1.26 | 12.6 | 14.66 | 1.58 | 19.6 | 17.48 | 1.88 | 27.8 | 20.33 | 2.19 | 37.6  | 23.18 | 2.49 | 48.9  | 26.03 | 2.80 | 61.7  |
| 6                      | 6.53                      | 0.94 | 6.9  | 9.50  | 1.36 | 14.6 | 12.32 | 1.77 | 24.6 | 15.30 | 2.19 | 37.9 | 18.19 | 2.61 | 53.5 | 21.04 | 3.02 | 71.7  | 23.72 | 3.40 | 91.0  | 26.75 | 3.83 | 115.8 |
| <b>MDKT3H-1400G70</b>  |                           |      |      |       |      |      |       |      |      |       |      |      |       |      |      |       |      |       |       |      |       |       |      |       |
| Δt                     | Air inlet temp. (20°C DB) |      |      |       |      |      |       |      |      |       |      |      |       |      |      |       |      |       |       |      |       |       |      |       |
|                        | Water inlet temp. (°C)    |      |      |       |      |      |       |      |      |       |      |      |       |      |      |       |      |       |       |      |       |       |      |       |
|                        | 35                        |      |      | 40    |      |      | 45    |      |      | 50    |      |      | 55    |      |      | 60    |      |       | 65    |      |       | 70    |      |       |
|                        | TH                        | WF   | WPD  | TH    | WF   | WPD  | TH    | WF   | WPD  | TH    | WF   | WPD  | TH    | WF   | WPD  | TH    | WF   | WPD   | TH    | WF   | WPD   | TH    | WF   | WPD   |
| 10                     | 6.08                      | 0.52 | 1.7  | 9.53  | 0.82 | 4.2  | 13.20 | 1.14 | 8.1  | 16.66 | 1.43 | 12.9 | 20.13 | 1.73 | 18.8 | 23.67 | 2.04 | 26.0  | 27.09 | 2.33 | 34.1  | 30.50 | 2.62 | 43.2  |
| 8                      | 6.74                      | 0.72 | 3.3  | 10.49 | 1.13 | 8.0  | 14.06 | 1.51 | 14.3 | 17.53 | 1.88 | 22.3 | 20.90 | 2.25 | 31.7 | 24.31 | 2.61 | 42.9  | 27.73 | 2.98 | 55.8  | 31.14 | 3.35 | 70.4  |
| 6                      | 7.81                      | 1.12 | 7.9  | 11.37 | 1.63 | 16.7 | 14.74 | 2.11 | 28.0 | 18.30 | 2.62 | 43.2 | 21.76 | 3.12 | 61.1 | 25.17 | 3.61 | 81.7  | 28.37 | 4.07 | 103.9 | 31.99 | 4.59 | 132.1 |
| <b>MDKT3H-1600G100</b> |                           |      |      |       |      |      |       |      |      |       |      |      |       |      |      |       |      |       |       |      |       |       |      |       |
| Δt                     | Air inlet temp. (20°C DB) |      |      |       |      |      |       |      |      |       |      |      |       |      |      |       |      |       |       |      |       |       |      |       |
|                        | Water inlet temp. (°C)    |      |      |       |      |      |       |      |      |       |      |      |       |      |      |       |      |       |       |      |       |       |      |       |
|                        | 35                        |      |      | 40    |      |      | 45    |      |      | 50    |      |      | 55    |      |      | 60    |      |       | 65    |      |       | 70    |      |       |
|                        | TH                        | WF   | WPD  | TH    | WF   | WPD  | TH    | WF   | WPD  | TH    | WF   | WPD  | TH    | WF   | WPD  | TH    | WF   | WPD   | TH    | WF   | WPD   | TH    | WF   | WPD   |
| 10                     | 7.14                      | 0.61 | 2.8  | 11.20 | 0.96 | 6.9  | 15.51 | 1.33 | 13.1 | 19.57 | 1.68 | 20.9 | 23.66 | 2.03 | 30.6 | 27.81 | 2.39 | 42.2  | 31.82 | 2.74 | 55.3  | 35.83 | 3.08 | 70.1  |
| 8                      | 7.92                      | 0.85 | 5.4  | 12.33 | 1.33 | 13.0 | 16.51 | 1.78 | 23.3 | 20.60 | 2.21 | 36.2 | 24.56 | 2.64 | 51.5 | 28.57 | 3.07 | 69.6  | 32.58 | 3.50 | 90.5  | 36.59 | 3.93 | 114.2 |
| 6                      | 9.17                      | 1.31 | 12.8 | 13.36 | 1.91 | 27.1 | 17.32 | 2.48 | 45.5 | 21.50 | 3.08 | 70.1 | 25.56 | 3.66 | 99.1 | 29.57 | 4.24 | 132.6 | 33.33 | 4.78 | 168.5 | 37.59 | 5.39 | 214.3 |
| <b>MDKT3H-1800G100</b> |                           |      |      |       |      |      |       |      |      |       |      |      |       |      |      |       |      |       |       |      |       |       |      |       |



| Air inlet temp. (20°C DB) |       |      |      |       |      |      |       |      |       |       |      |       |       |      |       |       |      |       |       |      |       |       |      |       |
|---------------------------|-------|------|------|-------|------|------|-------|------|-------|-------|------|-------|-------|------|-------|-------|------|-------|-------|------|-------|-------|------|-------|
| Water inlet temp. (°C)    |       |      |      |       |      |      |       |      |       |       |      |       |       |      |       |       |      |       |       |      |       |       |      |       |
| Δt                        | 35    |      |      | 40    |      |      | 45    |      |       | 50    |      |       | 55    |      |       | 60    |      |       | 65    |      |       | 70    |      |       |
|                           | TH    | WF   | WPD  | TH    | WF   | WPD  | TH    | WF   | WPD   | TH    | WF   | WPD   | TH    | WF   | WPD   | TH    | WF   | WPD   | TH    | WF   | WPD   | TH    | WF   | WPD   |
| 10                        | 8.07  | 0.69 | 5.2  | 12.66 | 1.09 | 12.9 | 17.53 | 1.51 | 24.7  | 22.12 | 1.90 | 39.4  | 26.74 | 2.30 | 57.5  | 31.44 | 2.70 | 74.5  | 35.97 | 3.09 | 104.1 | 40.50 | 3.48 | 132.0 |
| 8                         | 8.95  | 0.96 | 10.1 | 13.93 | 1.50 | 24.4 | 18.66 | 2.01 | 43.8  | 23.28 | 2.50 | 68.1  | 27.76 | 2.98 | 96.9  | 32.29 | 3.47 | 131.1 | 36.82 | 3.96 | 170.5 | 41.35 | 4.45 | 215.0 |
| 6                         | 10.37 | 1.49 | 24.0 | 15.10 | 2.16 | 50.9 | 19.57 | 2.81 | 85.6  | 24.30 | 3.48 | 132.0 | 28.89 | 4.14 | 186.6 | 33.42 | 4.79 | 249.7 | 37.67 | 5.40 | 317.2 | 42.48 | 6.09 | 403.4 |
| MDKT3H-2200G100           |       |      |      |       |      |      |       |      |       |       |      |       |       |      |       |       |      |       |       |      |       |       |      |       |
| Air inlet temp. (20°C DB) |       |      |      |       |      |      |       |      |       |       |      |       |       |      |       |       |      |       |       |      |       |       |      |       |
| Water inlet temp. (°C)    |       |      |      |       |      |      |       |      |       |       |      |       |       |      |       |       |      |       |       |      |       |       |      |       |
| Δt                        | 35    |      |      | 40    |      |      | 45    |      |       | 50    |      |       | 55    |      |       | 60    |      |       | 65    |      |       | 70    |      |       |
|                           | TH    | WF   | WPD  | TH    | WF   | WPD  | TH    | WF   | WPD   | TH    | WF   | WPD   | TH    | WF   | WPD   | TH    | WF   | WPD   | TH    | WF   | WPD   | TH    | WF   | WPD   |
| 10                        | 10.16 | 0.87 | 8.0  | 15.94 | 1.37 | 19.7 | 22.08 | 1.90 | 37.7  | 27.85 | 2.40 | 60.1  | 33.67 | 2.90 | 87.7  | 39.59 | 3.40 | 105.3 | 45.29 | 3.90 | 158.8 | 51.00 | 4.39 | 201.3 |
| 8                         | 11.27 | 1.21 | 15.4 | 17.55 | 1.89 | 37.2 | 23.50 | 2.53 | 66.8  | 29.32 | 3.15 | 103.9 | 34.95 | 3.76 | 147.8 | 40.66 | 4.37 | 199.9 | 46.36 | 4.98 | 260.0 | 52.07 | 5.60 | 327.9 |
| 6                         | 13.05 | 1.87 | 36.6 | 19.01 | 2.72 | 77.7 | 24.64 | 3.53 | 130.6 | 30.60 | 4.39 | 201.3 | 36.38 | 5.21 | 284.5 | 42.08 | 6.03 | 380.8 | 47.43 | 6.80 | 483.8 | 53.50 | 7.67 | 615.4 |

Heating capacity modification coefficient table:

| Speed | 800  | 1000 | 1200 | 1400 | 1600 | 1800 | 2200 |
|-------|------|------|------|------|------|------|------|
|       | TH   | TH   | TH   | TH   | TH   | TH   | TH   |
| High  | 1    | 1    | 1    | 1    | 1    | 1    | 1    |
| Mid   | 0.88 | 0.87 | 0.86 | 0.88 | 0.86 | 0.88 | 0.89 |
| Low   | 0.74 | 0.75 | 0.75 | 0.76 | 0.74 | 0.75 | 0.75 |

Altitude modification coefficient table:

| Altitude | TC   | SC   | TH   |
|----------|------|------|------|
| 500      | 0.98 | 0.95 | 0.95 |
| 1000     | 0.97 | 0.91 | 0.91 |
| 1500     | 0.95 | 0.86 | 0.86 |
| 2000     | 0.94 | 0.82 | 0.82 |
| 2500     | 0.93 | 0.78 | 0.78 |
| 3000     | 0.91 | 0.74 | 0.7  |

### 10. Static Pressure Graph

How to read the diagram

The vertical axis is the External Static Pressure (Pa) while the horizontal axis represents the Air Flow (m<sup>3</sup>/h).

#### MDKT3H-800(E)G70

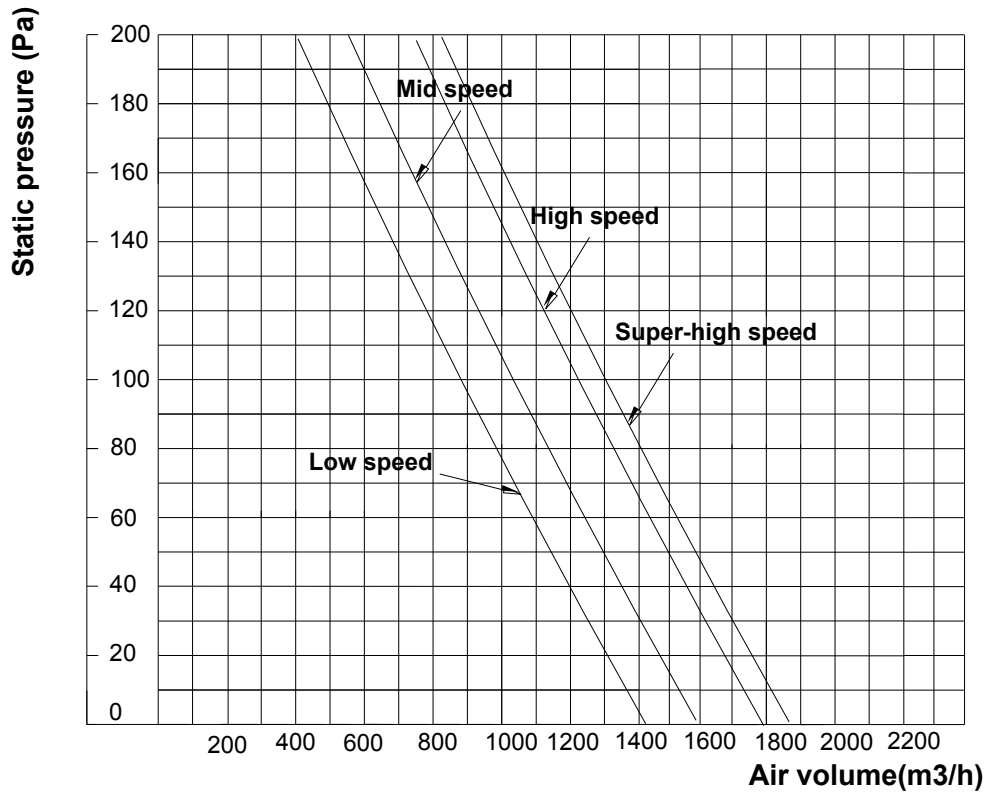

#### MDKT3H-1000(E)G70

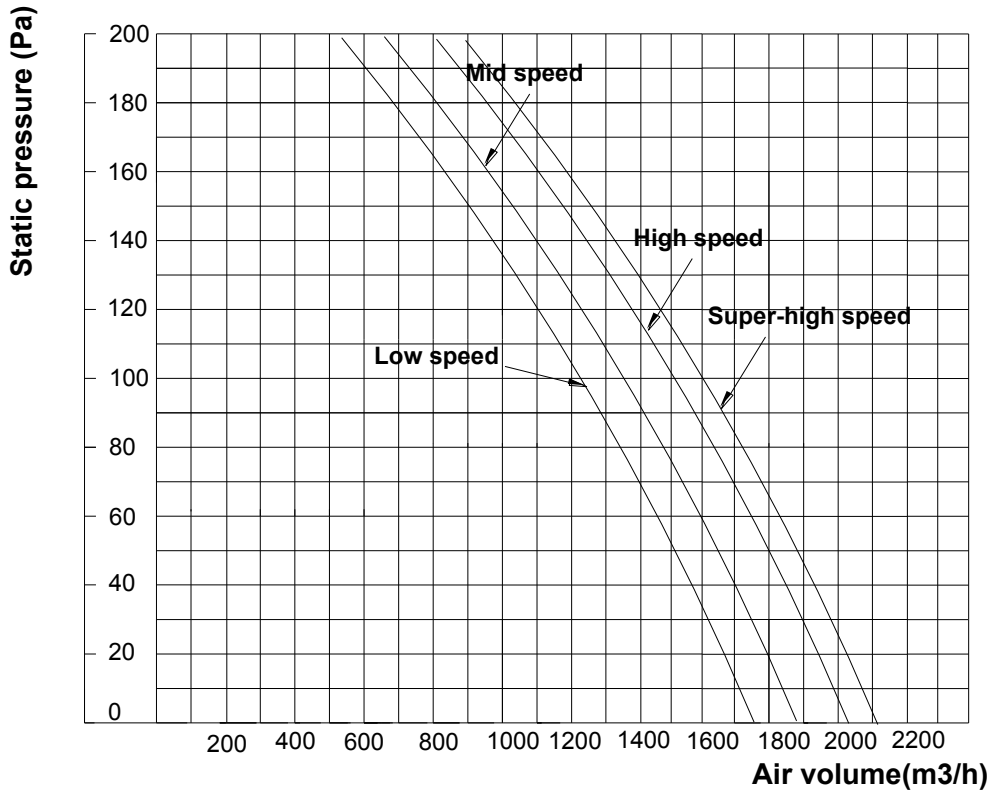

**MDKT3H-1200(E)G70**

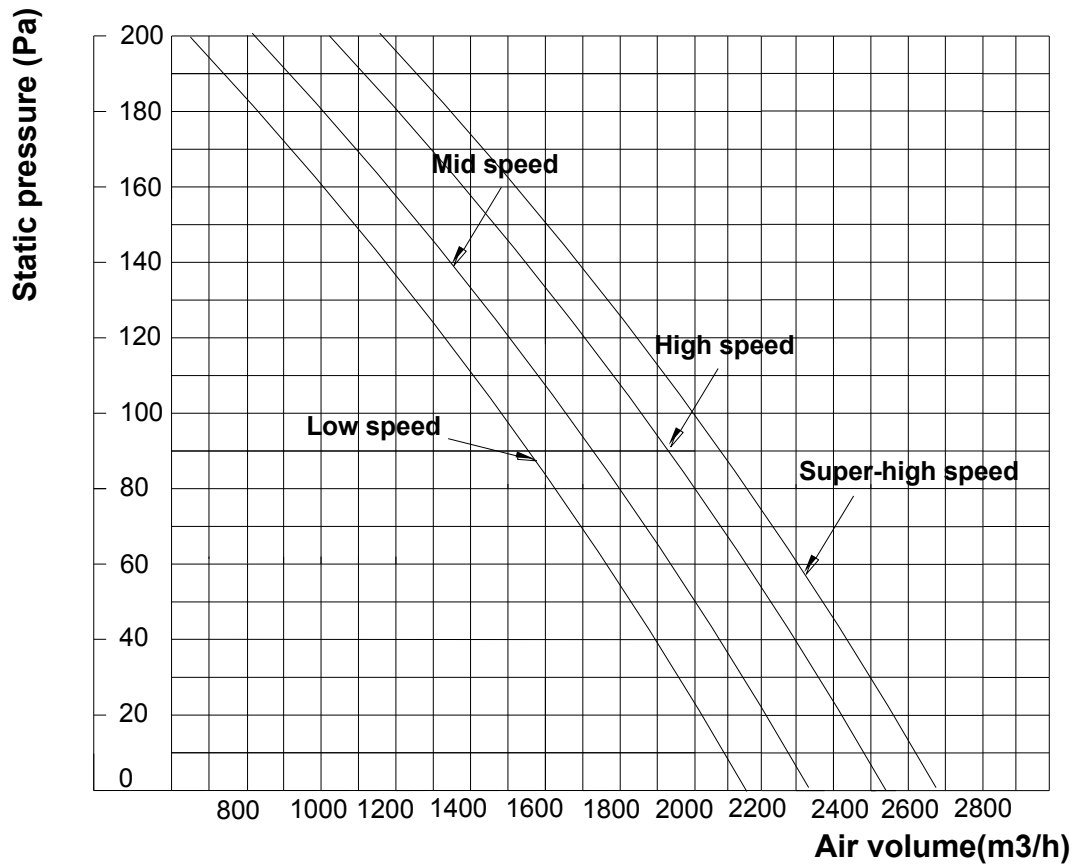

**MDKT3H-1400(E)G70**

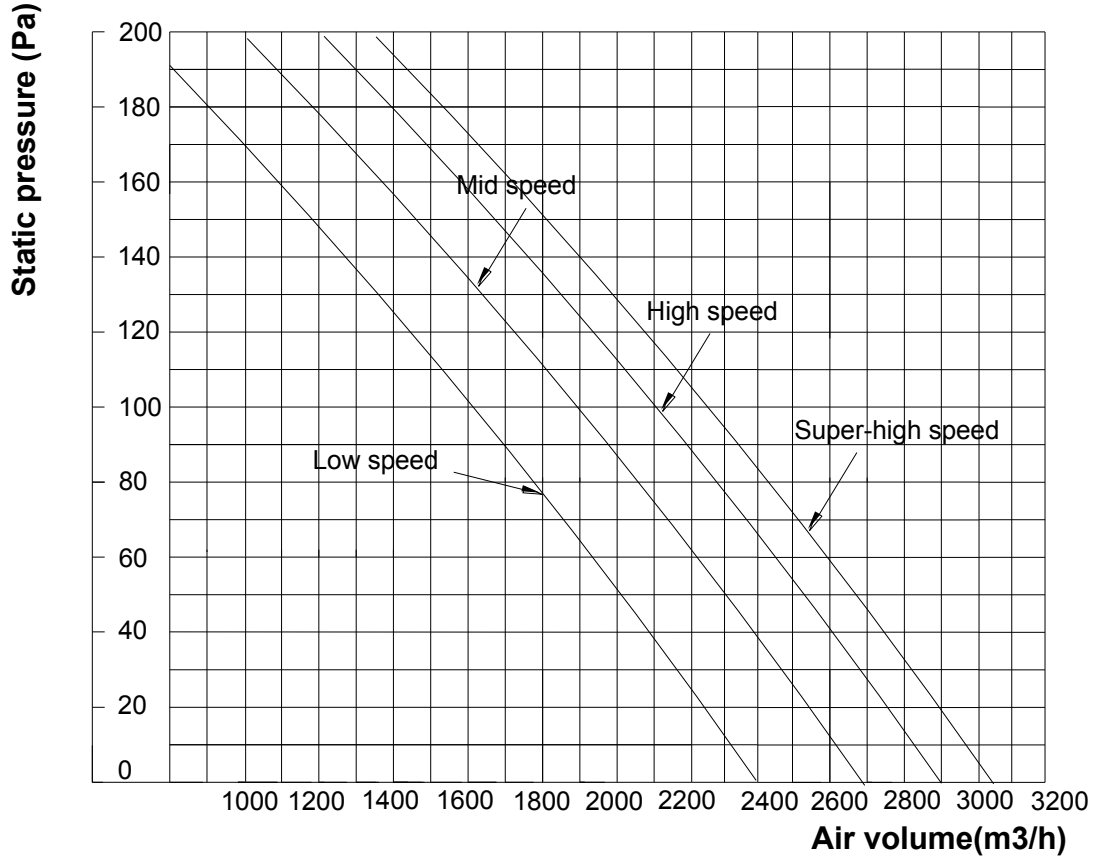

**MDKT3H-1600(E)G100**

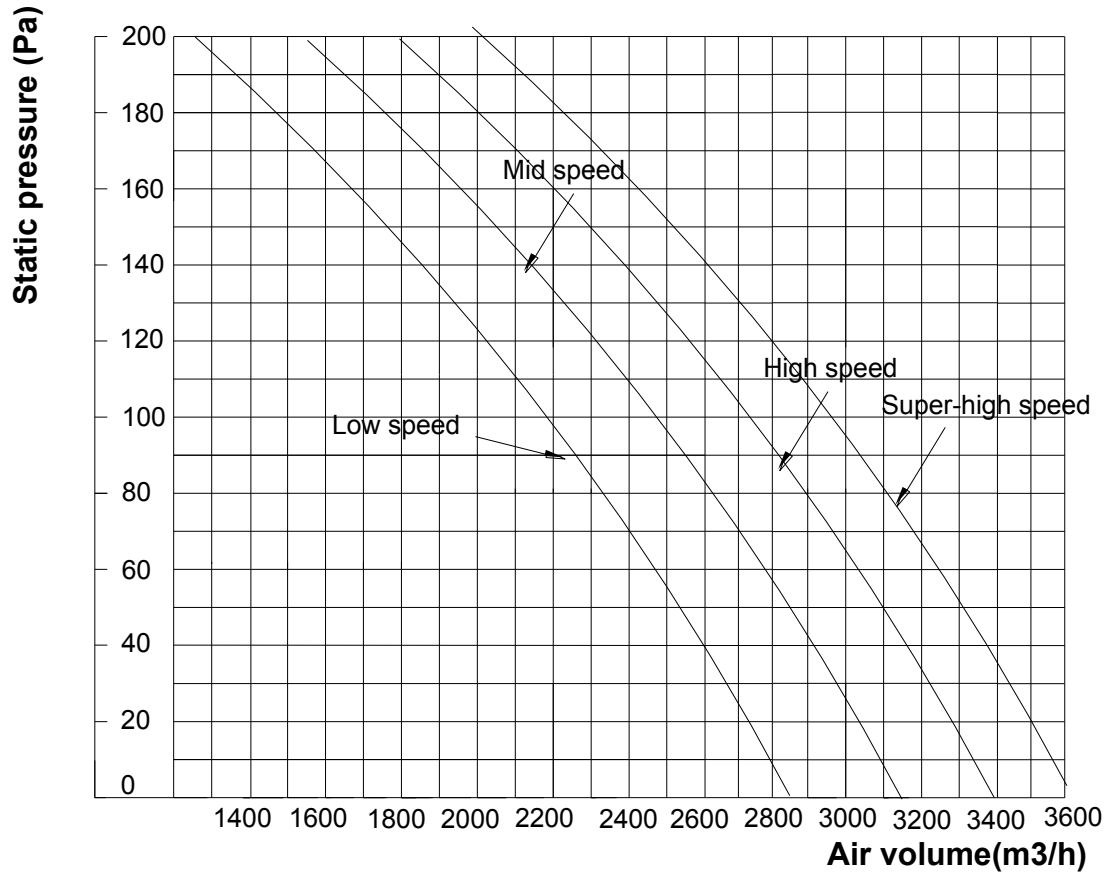

**MDKT3H-1800(E)G100**

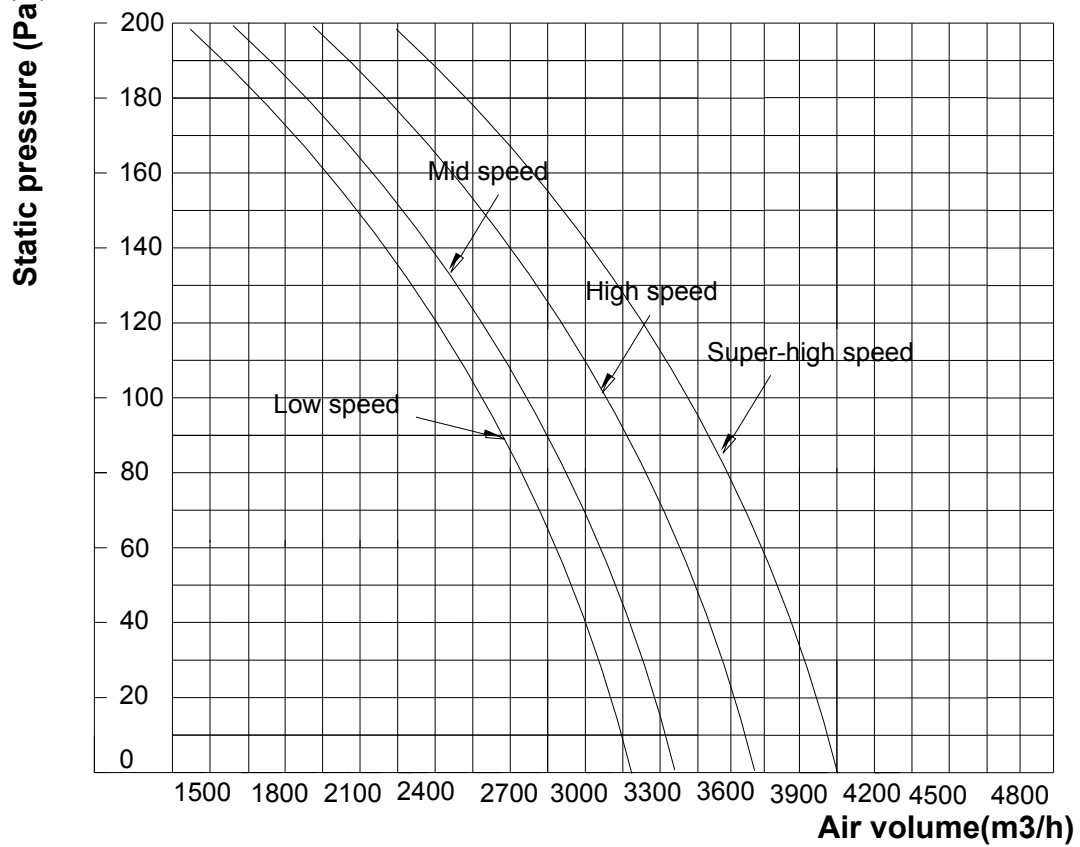

**MDKT3H-2200(E)G100**

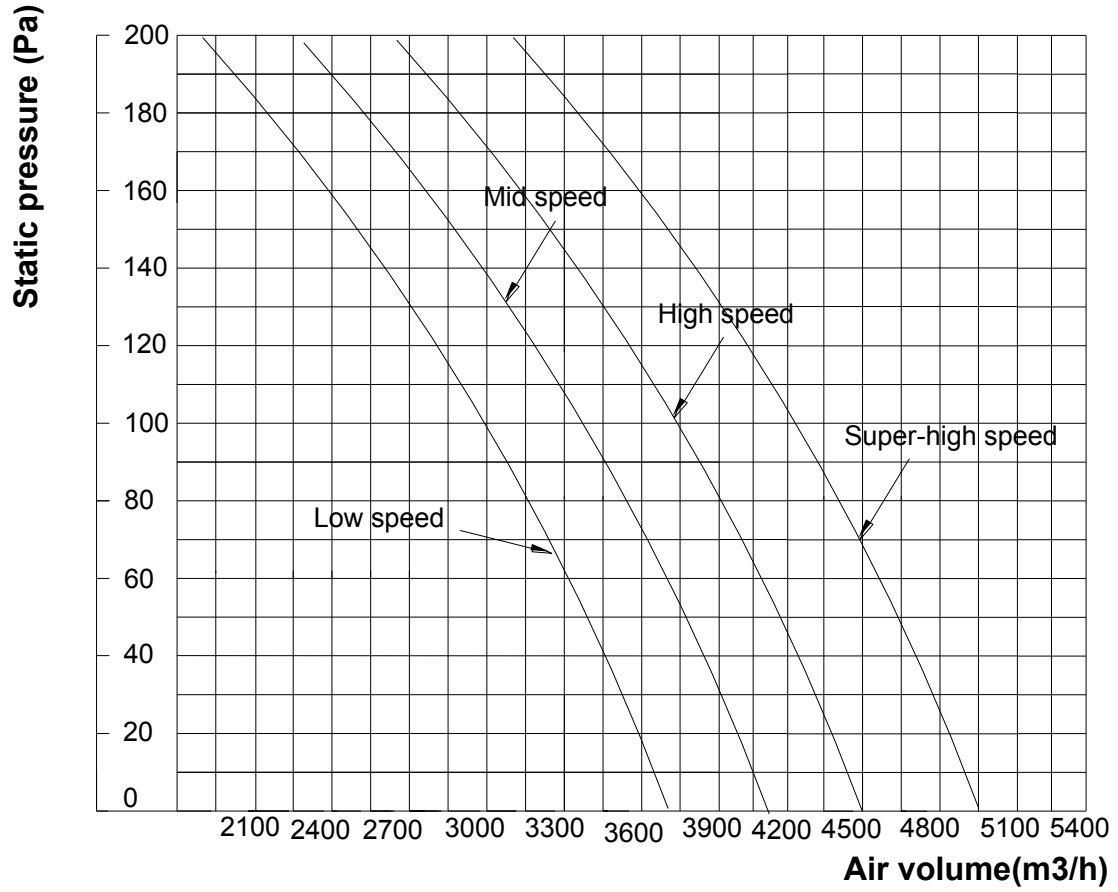

### 11. Exploded View

MDKT3H-800G70 MDKT3H-1000G70 MDKT3H-1200G70 MDKT3H-1400G70

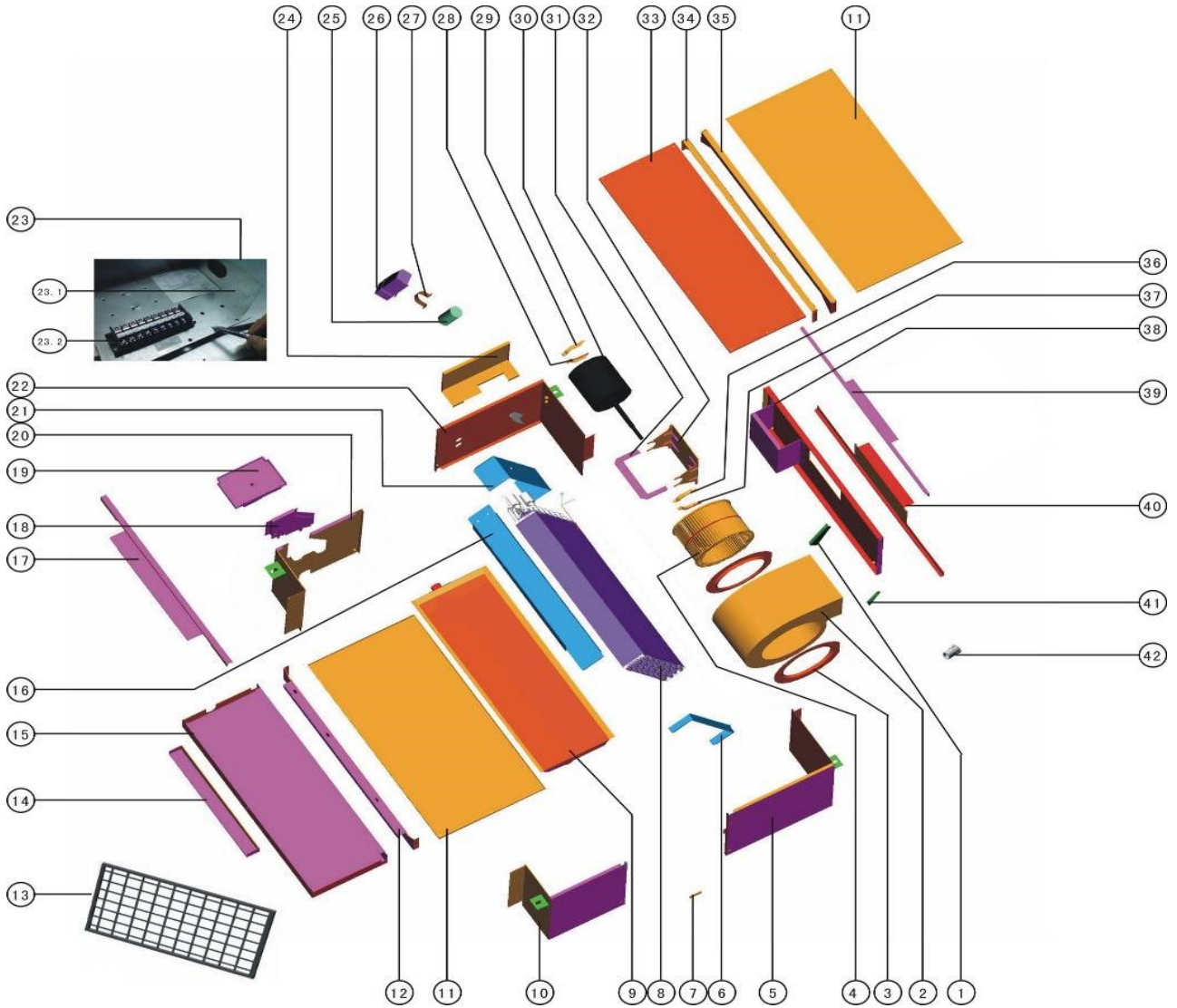

| No. | Part Name                 | Qua. | No.  | Part Name                   | Qua. | No. | Part Name                    | Qua. |
|-----|---------------------------|------|------|-----------------------------|------|-----|------------------------------|------|
| 1   | Right fixing board        | 1    | 16   | Baffle                      | 1    | 29  | Motor up cover               | 1    |
| 2   | Volute shell ass'y        | 1    | 17   | Back upside board ass'y     | 1    | 30  | Fan motor                    | 1    |
| 3   | Wind ring ass'y           | 2    | 18   | Cover plate ass'y           | 1    | 31  | Board                        | 1    |
| 4   | Centrifugal fan ass'y     | 1    | 19   | Drainage pan                | 1    | 32  | Motor bracket                | 1    |
| 5   | Side board ass'y          | 1    | 20   | Clapboard ass'y             | 1    | 33  | Rear cover ass'y             | 1    |
| 6   | Evaporator left clapboard | 1    | 21   | Evaporator right clapboard  | 1    | 34  | Beam ass'y                   | 1    |
| 7   | Stator                    | 2    | 22   | Front right clapboard ass'y | 1    | 35  | Beam ass'y                   | 1    |
| 8   | Evaporator ass'y          | 1    | 23   | E-part box ass'y            | 1    | 36  | Motor up cover               | 1    |
| 9   | Drainage pan ass'y        | 1    | 23.1 | E-part box                  | 1    | 37  | Motor below cover            | 1    |
| 10  | Clapboard ass'y           | 1    | 23.2 | Wire joint, 9p              | 1    | 38  | Base                         | 1    |
| 11  | Front cover ass'y         | 2    | 24   | E-Part box cover            | 1    | 39  | Former upside board ass'y    | 1    |
| 12  | Beam ass'y                | 1    | 25   | Capacitor box               | 1    | 40  | Former underside board ass'y | 1    |
| 13  | Air filter                | 1    | 26   | Pipe performing             | 1    | 41  | Left fixing board            | 1    |
| 14  | Back Underside board      | 1    | 27   | Capacitor                   | 1    | 42  | Water pipe                   | 1    |
| 15  | Base ass'y                | 1    | 28   | Motor below cover           | 1    |     |                              |      |

**MDKT3H-1600G100 MDKT3H-1800G100 MDKT3H-2200G100**

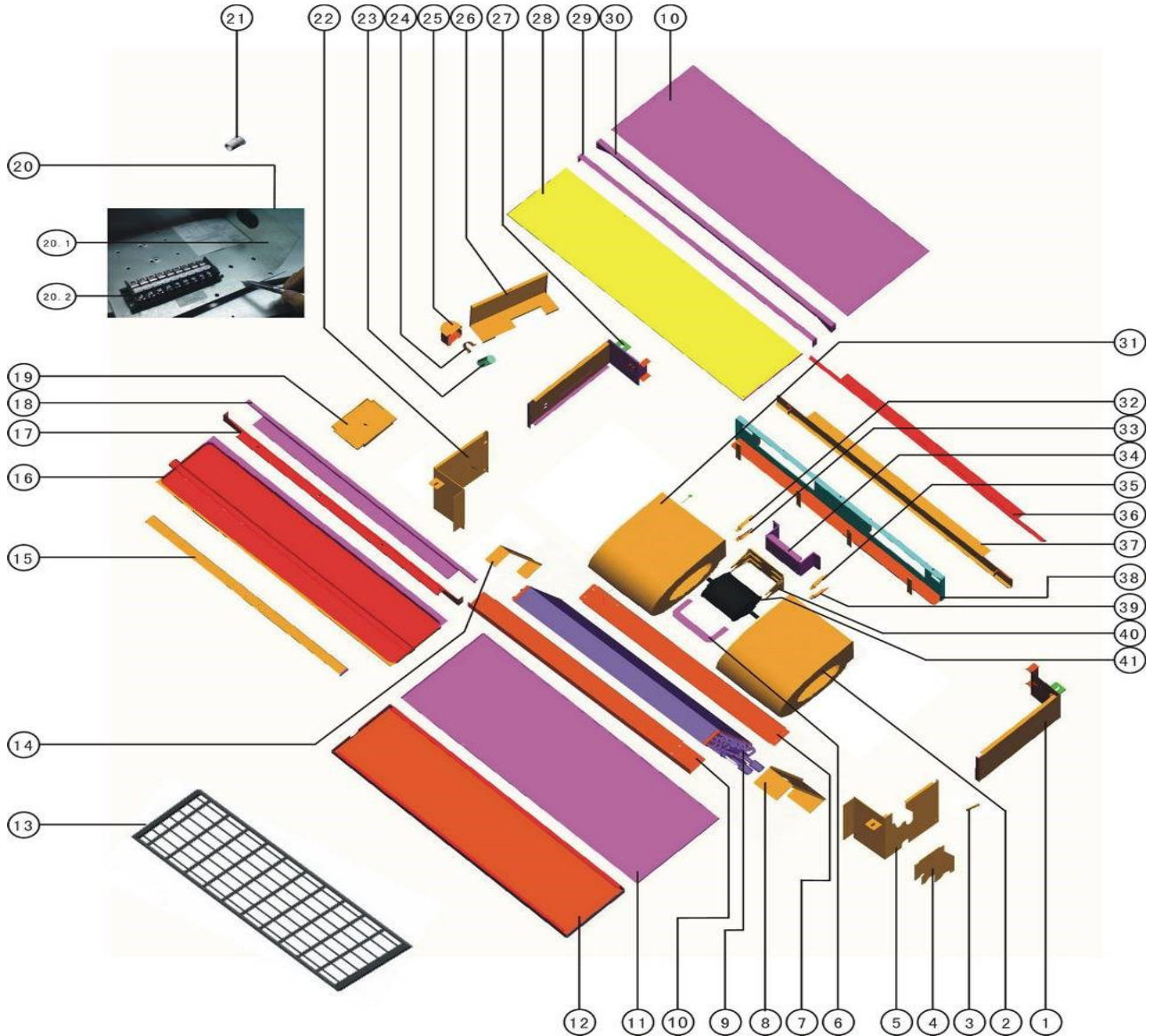

| No. | Part Name                        | Qua. | No.  | Part Name                   | Qua. | No. | Part Name                    | Qua. |
|-----|----------------------------------|------|------|-----------------------------|------|-----|------------------------------|------|
| 1   | Side board ass'y                 | 1    | 16   | Drainage pan ass'y          | 1    | 29  | Beam ass'y                   | 1    |
| 2   | Fan ass'y                        | 1    | 17   | Beam ass'y                  | 1    | 30  | Beam ass'y                   | 1    |
| 3   | Stator                           | 2    | 18   | Back upside board ass'y     | 1    | 31  | Right wind wheel ass'y       | 1    |
| 4   | Cover plate ass'y                | 1    | 19   | Drainage pan                | 1    | 32  | Motor up cover               | 1    |
| 5   | Clapboard ass'y                  | 1    | 20   | E-part box ass'y            | 1    | 33  | Motor below cover            | 1    |
| 6   | Board                            | 1    | 20.1 | E-part box                  | 1    | 34  | Fixing board ass'y           | 1    |
| 7   | Below baffle                     | 1    | 20.2 | Wire joint, 9p              | 1    | 35  | Motor up cover               | 1    |
| 8   | Evaporator left clapboard ass'y  | 1    | 21   | Water pipe                  | 1    | 36  | Former upside board ass'y    | 1    |
| 9   | Evaporator ass'y                 | 1    | 22   | Clapboard ass'y             | 1    | 37  | Former underside board ass'y | 1    |
| 10  | Evaporator up clapboard ass'y    | 1    | 23   | Capacitor                   | 1    | 38  | Fixing board ass'y           | 1    |
| 11  | Front cover ass'y                | 2    | 24   | Capacitor clamp             | 1    | 39  | Motor below cover            | 1    |
| 12  | Base ass'y                       | 1    | 25   | Capacitor box               | 1    | 40  | Motor bracket                | 1    |
| 13  | Air filter                       | 1    | 26   | E-Part box cover            | 1    | 41  | Motor                        | 1    |
| 14  | Evaporator right clapboard ass'y | 1    | 27   | Front right clapboard ass'y | 1    |     |                              |      |
| 15  | Back Underside board             | 1    | 28   | Rear cover ass'y            | 1    |     |                              |      |

**MDKT3H-800EG70 MDKT3H-1000EG70 MDKT3H-1200EG70 MDKT3H-1400EG70**

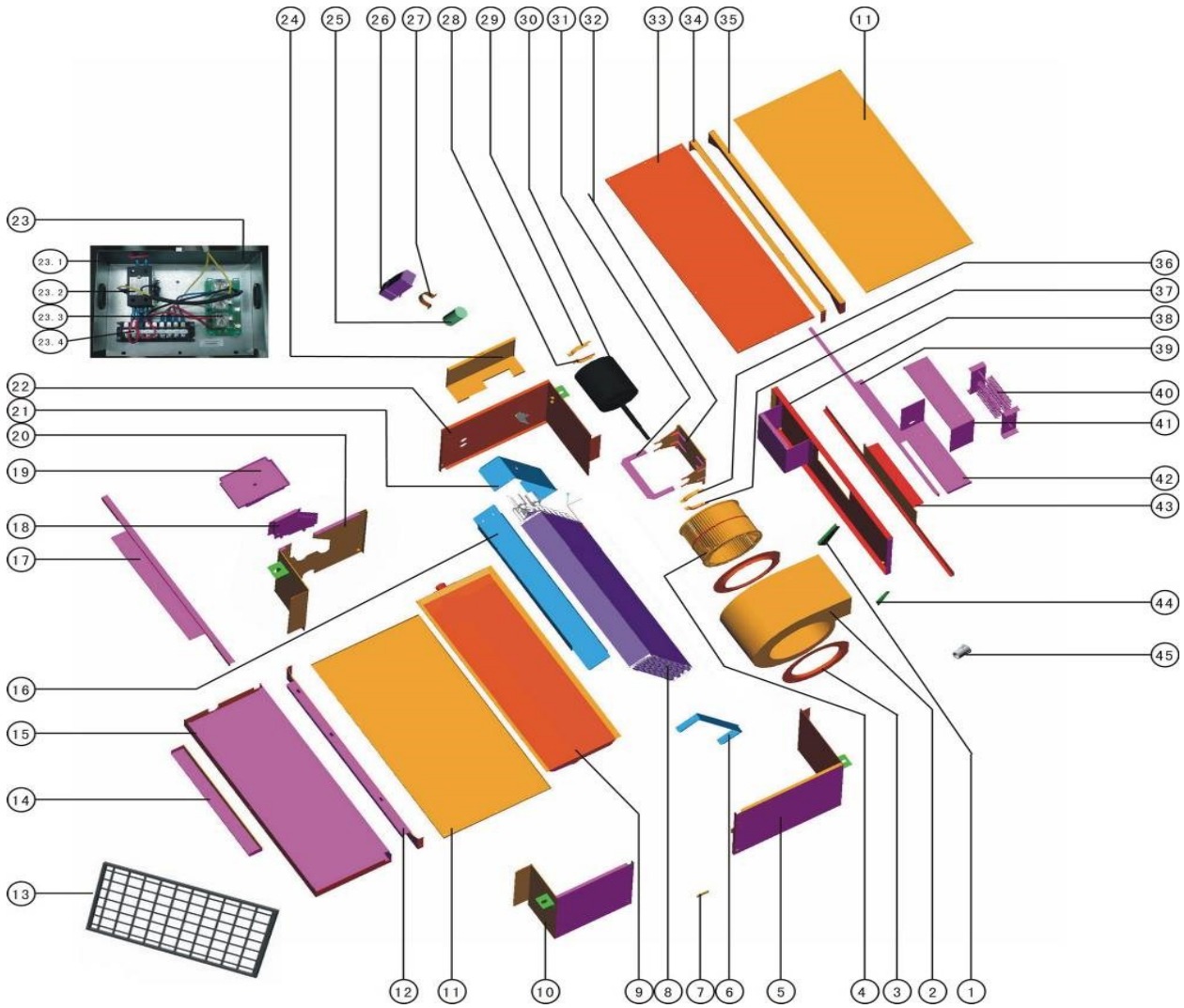

| No. | Part Name                 | Qua. | No.  | Part Name                   | Qua. | No. | Part Name                    | Qua. |
|-----|---------------------------|------|------|-----------------------------|------|-----|------------------------------|------|
| 1   | Right fixing board        | 1    | 18   | Cover plate ass'y           | 1    | 31  | Board                        | 1    |
| 2   | Volute shell ass'y        | 1    | 19   | Drainage pan                | 1    | 32  | Motor bracket                | 1    |
| 3   | Wind ring ass'y           | 2    | 20   | Clapboard ass'y             | 1    | 33  | Rear cover ass'y             | 1    |
| 4   | Centrifugal fan ass'y     | 1    | 21   | Evaporator right clapboard  | 1    | 34  | Beam ass'y                   | 1    |
| 5   | Side board ass'y          | 1    | 22   | Front right clapboard ass'y | 1    | 35  | Beam ass'y                   | 1    |
| 6   | Evaporator left clapboard | 1    | 23   | E-part box ass'y            | 1    | 36  | Motor up cover               | 1    |
| 7   | Stator                    | 2    | 23.1 | E-part box                  | 1    | 37  | Motor below cover            | 1    |
| 8   | Evaporator ass'y          | 1    | 23.2 | Contactor                   | 1    | 38  | Base                         | 1    |
| 9   | Drainage pan ass'y        | 1    | 23.3 | Relay control board ass'y   | 1    | 39  | Former upside board ass'y    | 1    |
| 10  | Clapboard ass'y           | 1    | 23.4 | Wire joint, 9p              | 1    | 40  | Electric heater ass'y        | 1    |
| 11  | Front cover ass'y         | 2    | 24   | E-Part box cover            | 1    | 41  | Board II                     | 1    |
| 12  | Beam ass'y                | 1    | 25   | Capacitor box               | 1    | 42  | Board I                      | 1    |
| 13  | Air filter                | 1    | 26   | Pipe performing             | 1    | 43  | Former underside board ass'y | 1    |
| 14  | Back Underside board      | 1    | 27   | Capacitor                   | 1    | 44  | Left fixing board            | 1    |
| 15  | Base ass'y                | 1    | 28   | Motor below cover           | 1    | 45  | Water pipe                   | 1    |
| 16  | Baffle                    | 1    | 29   | Motor up cover              | 1    |     |                              |      |
| 17  | Back upside board ass'y   | 1    | 30   | Fan motor                   | 1    |     |                              |      |



**MDKT3H-1600EG100 MDKT3H-1800EG100 MDKT3H-2200EG100**

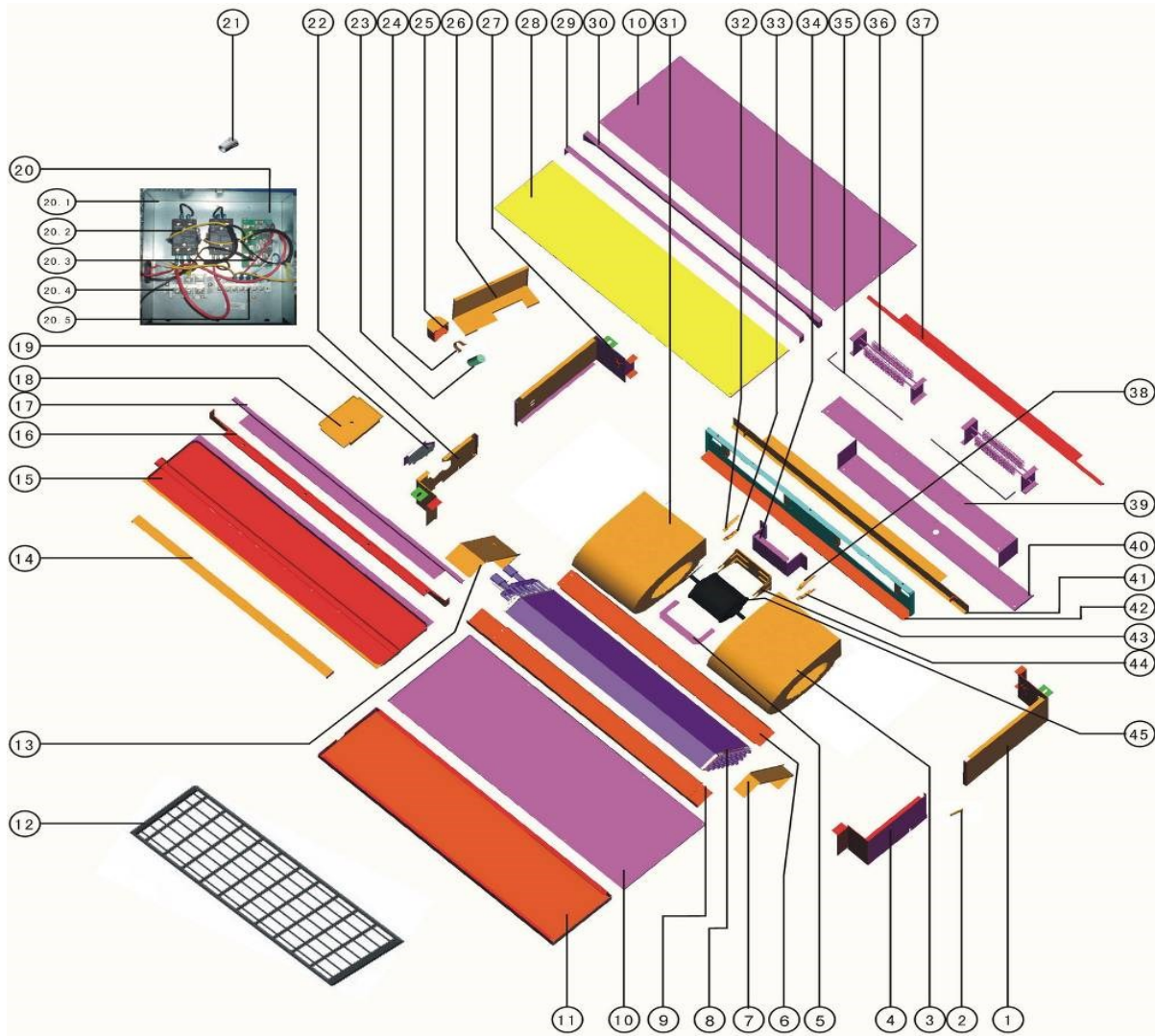

| No. | Part Name               | Qua. | No.  | Part Name                   | Qua. | No. | Part Name                    | Qua. |
|-----|-------------------------|------|------|-----------------------------|------|-----|------------------------------|------|
| 1   | Side board ass'y        | 1    | 18   | Drainage pan                | 1    | 30  | Beam ass'y                   | 1    |
| 2   | Stator                  | 2    | 19   | Cover plate ass'y           | 1    | 31  | Right wind wheel ass'y       | 1    |
| 3   | Fan ass'y               | 1    | 20   | E-part box ass'y            | 1    | 32  | Motor up cover               | 1    |
| 4   | Clapboard ass'y         | 1    | 20.1 | E-part box                  | 1    | 33  | Motor below cover            | 1    |
| 5   | Board                   | 1    | 20.2 | Contactor                   | 2    | 34  | Fixing board ass'y           | 1    |
| 6   | Below baffle            | 1    | 20.3 | Relay control board ass'y   | 1    | 35  | Baffle bar                   | 2    |
| 7   | Left fixation board     | 1    | 20.4 | Wire joint, 3p              | 1    | 36  | Electric heater ass'y        | 2    |
| 8   | Evaporator ass'y        | 1    | 20.5 | Wire joint                  | 1    | 37  | Former upside board ass'y    | 1    |
| 9   | Protection board        | 1    | 21   | Water pipe                  | 1    | 38  | Motor up cover               | 1    |
| 10  | Front cover ass'y       | 2    | 22   | Clapboard ass'y             | 1    | 39  | Board I                      | 1    |
| 11  | Base ass'y              | 1    | 23   | Compressor capacitor        | 1    | 40  | Board                        | 2    |
| 12  | Air filter              | 1    | 24   | Capacitor clamp             | 1    | 41  | Former underside board ass'y | 1    |
| 13  | Right fixing board      | 1    | 25   | Compressor capacitor box    | 1    | 42  | Fixing board ass'y           | 1    |
| 14  | Back Underside board    | 1    | 26   | E-Part box cover            | 1    | 43  | Motor below cover            | 1    |
| 15  | Drainage pan ass'y      | 1    | 27   | Front right clapboard ass'y | 1    | 44  | Motor bracket                | 1    |
| 16  | Beam ass'y              | 1    | 28   | Rear cover ass'y            | 1    | 45  | Motor                        | 1    |
| 17  | Back upside board ass'y | 1    | 29   | Beam ass'y                  | 1    |     |                              |      |

## 12. Installation

### 12.1 Installation of the fan coil unit

- Precautions before installation.
  - Decide the correct way of conveying the equipment.
  - Try to transport this equipment with the original package.
  - If the air conditioner needs to be installed on a metal part of the building, electric insulation must be performed, and the installation must meet the relevant technical standards of electric devices.
- Install F10 pendant bolts (4 bolts)
  - The intervals of the pendant bolts are shown in the following figure.
  - Use the F10 pendant bolts.
  - The treatment of the ceiling varies between buildings. For detailed measures, negotiate with the construction and fit-out staff.
- Scope of dismantling the ceiling...Please keep the ceiling horizontal. Reinforce the beams and girders of the ceiling lest vibration of the ceiling.
- Cut off the beams and girders of the ceiling.
- Reinforce the cut-off part, beams and girders of the ceiling.
  - After the main body is suspended, work on the pipes and wires in the ceiling. Decide the lead-out direction of the pipes after selecting the installation site. Especially, in a circumstance where a ceiling is available, extend the refrigerant pipe; drain pipe, indoor/outdoor connection wires and wire controller lines to the connection position before suspending the unit.
  - Procedure of installing the pendant bolts.

**Wooden structure:** Put rectangular sticks across the beams, and set pendant bolts.

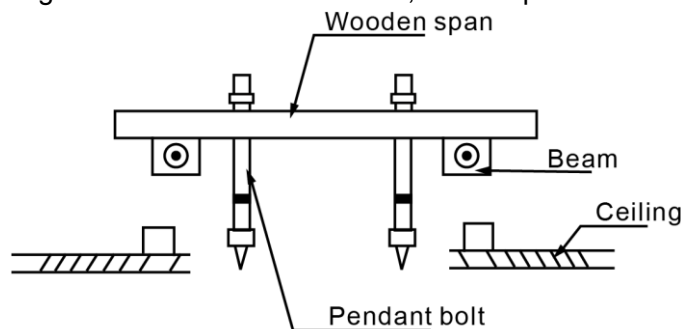

**New concrete roughcast:** Set it with embedded bushes or embedded bolts.

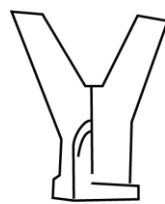

(Blade plug-in unit)

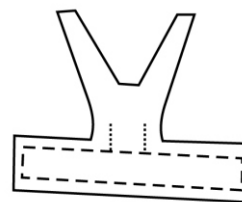

(Slide plug-in unit)

**Old concrete roughcast:** Use embedded bolts, embedded pulling plugs, and embedded stick harness.

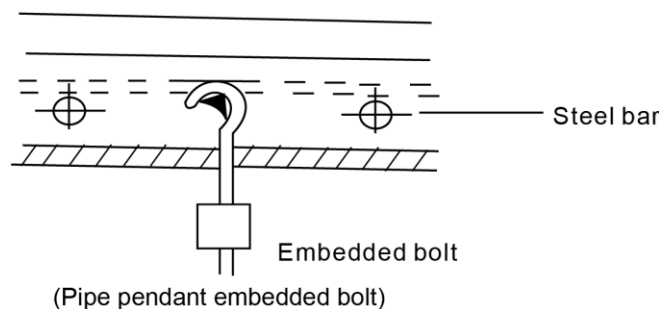

**Steel beam and grider structure:** Set and use supportive angle steel.

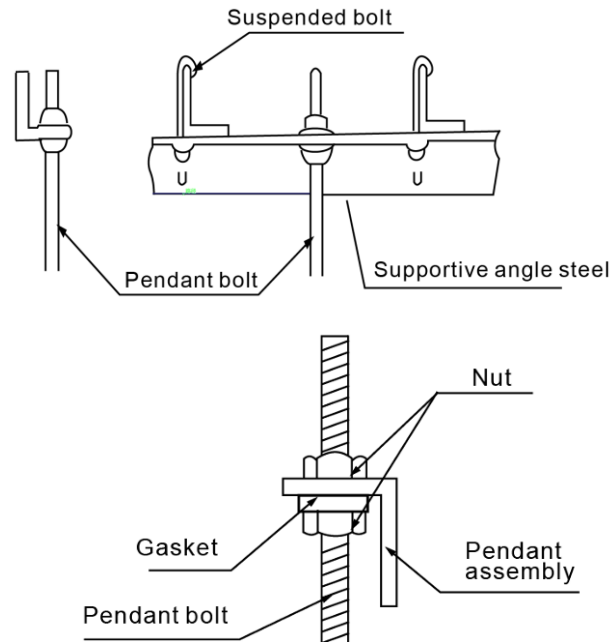

- Suspending the indoor unit
  - Use tools such as pulleys to hoist the indoor unit to the pendant bolt.
  - Use tools such as gradient to settle the indoor unit horizontally. Lack of horizontality may cause water leak.

- Connect the duct

The external static pressure is 70Pa or 100Pa, and the duct length is determined according to this parameter.

- Install the wire control switch

For installation of the wire control switch, see the installation manual of the wire controller.

- Sample unit specification figure: refer to chapter 7

## 12.2 Pipes Connection

- With air release valve, the other side is water inlet pipe.
- When connect water collector, set the tightening torque to 6180~7540N.cm(630~770kgf.cm), and use a spanner to tighten it as shown in Fig..
- The diameter of connective junction in water inlet pipe and water outlet pipe is RC3/4 taper pipe thread inside.
- The diameter of condensate pipe is ZG3/4 taper pipe thread outside.

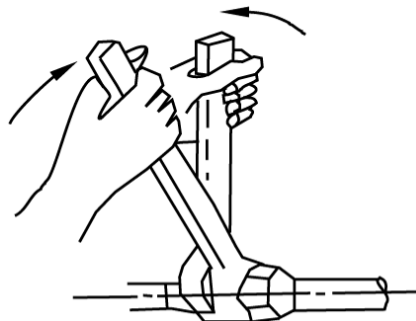

## 12.3 Installing Drainage Pipe

### Cautions:

- Be sure to perform heat insulation for the drain pipe of the indoor unit. Otherwise, condensate will occur. The joint of the indoor unit should also undergo heat insulation treatment.
- When performing the en suite connection, use the rigid PVC binder, and make sure that no leak exists.

- Same as the joint of the indoor unit. Be careful not to apply force at the pipe side of the indoor unit.
- The downward gradient of the drain pipe should be higher than (1/100), without bend in the middle.
- The widthwise stretch of the drain pipe should be with 1in 2110m. If the drain pipe is long, set up brackets to support it.
- The centralized pipes should be distributed against the figure shown on the right side.

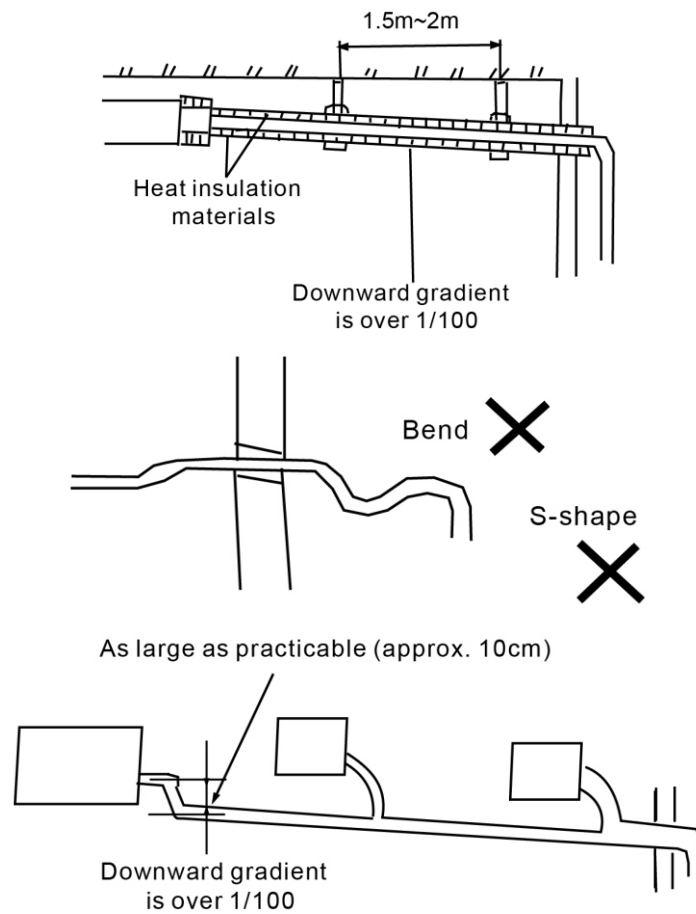

- Drain test
  - Before the test, ensure that the drain pipes are smooth and the adapters are sealed.
  - Newly built rooms should undergo the drain test before the ceiling is laid.

**12.4 Wiring**

| Fan coil units model | Name of cable         | Cable Qty. | Specification(Optional)           | Note                         |
|----------------------|-----------------------|------------|-----------------------------------|------------------------------|
| MDKT3H-800G70        | Main power cord       | 1          | RVV-300/500 3×2.5 mm <sup>2</sup> | Owner purchase it optionally |
| MDKT3H-1000G70       | Controller power cord | 1          | RVV-300/500 3×2.0 mm <sup>2</sup> | Owner purchase it optionally |
| MDKT3H-1200G70       | Control wire          | 1          | RVV-300/500 5×1.5 mm <sup>2</sup> | Owner purchase it optionally |
| MDKT3H-1400G70       |                       |            |                                   |                              |
| MDKT3H-1600G100      |                       |            |                                   |                              |
| MDKT3H-1800G100      |                       |            |                                   |                              |
| MDKT3H-2200G100      |                       |            |                                   |                              |
| MDKT3H-800EG70       | Main power cord       | 1          | RVV-300/500 3×3.3 mm <sup>2</sup> | Owner purchase it optionally |
| MDKT3H-1000EG70      | Controller power cord | 1          | RVV-300/500 3×2.0 mm <sup>2</sup> | Owner purchase it optionally |
| MDKT3H-1200EG70      | Control wire          | 1          | RVV-300/500 5×1.5 mm <sup>2</sup> | Owner purchase it optionally |
| MDKT3H-1400EG70      |                       |            |                                   |                              |
| MDKT3H-1600EG100     | Main power cord       | 1          | RVV-300/500 3×6.0 mm <sup>2</sup> | Owner purchase it optionally |
| MDKT3H-1800EG100     | Controller power cord | 1          | RVV-300/500 3×2.0 mm <sup>2</sup> | Owner purchase it optionally |
| MDKT3H-2200EG100     | Control wire          | 1          | RVV-300/500 5×1.5 mm <sup>2</sup> | Owner purchase it optionally |